

# PARTS LIST

EFFECTIVE DATE	MODEL NUMBER	PRODUCT GROUP
OCTOBER 1994	WF-48 REVISED	FAN

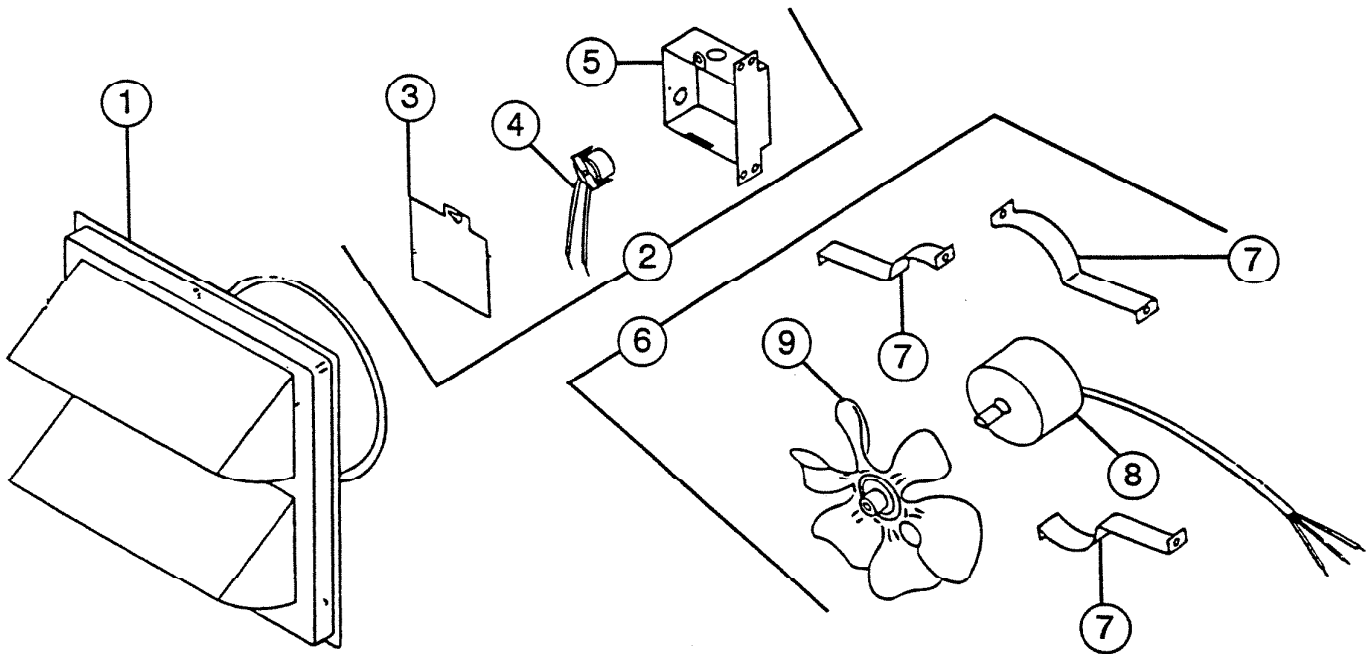

REF.	ORIGINAL PART NO.	*PART DESCRIPTION	MODEL USED ON	CURRENT REPLACEMENT PART NO.
1	66387	WALL PANEL ASSEMBLY	WF-48	Void - not avail.
2	1250A	OUTLET BOX AND COVER ASSEMBLY	WF-48	Void - not avail.
3	64648	OUTLET BOX COVER ONLY	WF-48	68644-000
4	66381	THERMOSTAT	WF-48	Void - not avail.
5	66380	OUTLET BOX ONLY	WF-48	Void - not avail.
6	66374	MOTOR BLOCK AND BRACKET	WF-48	Void - not avail.
7	66376	MOTOR MOUNTING BRACKET (1) - 3 Required	WF-48	Void - not avail.
8	66375	MOTOR $\frac{3}{8}$ " SHAFT - No.'s on Motor Data Plate JA2R127N, 8254110370	WF-48	Void - not avail.
9	66377	FAN BALD $\frac{3}{8}$ " Dia Hub	WF-48	Void - not avail.

# NuTone

NuTone  
 Attn: Parts Department  
 Madison & Red Bank Rds.  
 Cincinnati, OH 45227-1599  
 Phone: (513) 527-5426  
 Fax: (513) 527-5173

NOTE: Always order by current part number