

PARTS LIST

EFFECTIVE DATE	MODEL NUMBER	PRODUCT GROUP
JANUARY 1995	VC-307AN VC-307C2N VF-307CN REVISED	FAN

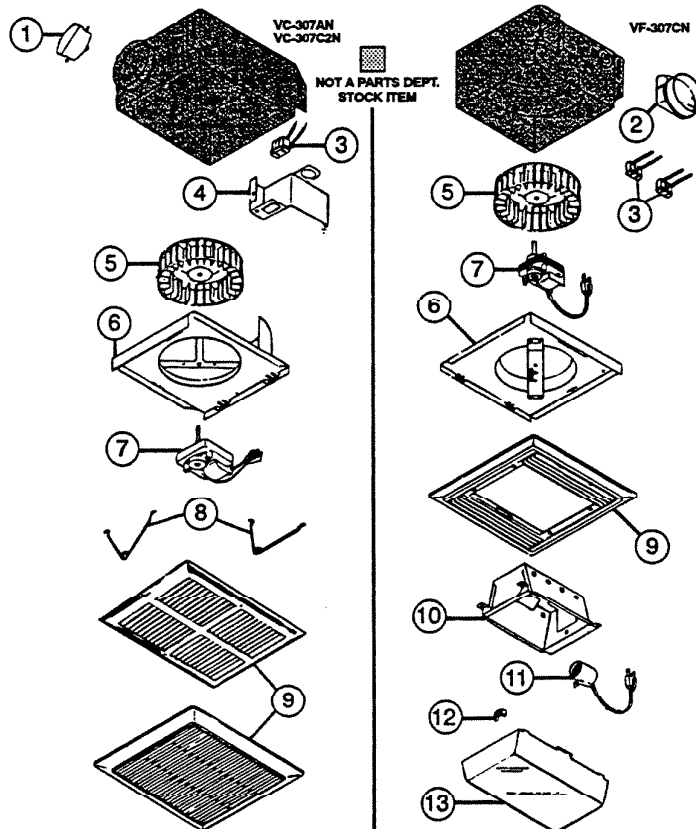

REF.	ORIGINAL PART NO.	*PART DESCRIPTION	MODEL USED ON	CURRENT REPLACEMENT PART NO.
1	29865	LOUVER	VC-307AN VC-307C2N	29865-000
2	K3143	DUCT ADAPTOR	VF-307CN	30652-000
3	10034	RECEPTACLE (1)	VC-307CN VC-307C2N VF-307CN	10034-000
4	29864	OUTLET BOX	VC-307AN VC-307C2N	29864-000
(PLEASE SEE OTHER SIDE)				

NuTone

NuTone
Attn: Parts Department
Madison & Red Bank Rds.
Cincinnati, OH 45227-1599
Phone: (513) 527-5426
Fax: (513) 527-5173

NOTE: Always order by
current part number

REF.	ORIGINAL PART NO.	*PART DESCRIPTION	MODEL USED ON	CURRENT REPLACEMENT PART NO.	
5	68739	BLOWER WHEEL	VC-307AN VC-307C2N VF-307CN	68739-000	
6	34829	MOUNTING PLATE	VC-307AN VC-307C2N	34829-000	
	K4172		VF-307CN	0423A-000	
7	34483	MOTOR	VC-307AN VC-307C2N	34483-000	
	K4283		VF-307CN	68737-000	
8	29861	SPRING SET (2)	VC-307AN VC-307C2N	0442A-000	
9	32884	GRILLE (With Springs) — If Used	METAL	VC-307AN	32884-000
	53098		PLASTIC	VC-307C2N	53098-000
	K4181			VF-307CN	53079-000
10	K4182	REFLECTOR	VF-307CN	33359-000	
11	K4183	LAMP SOCKET	VF-307CN	33600-000	
12	K4186	WING NUT — 1/4 x 20	VF-307CN	16133-000	
13	K4187	LENS	VF-307CN	65776-000	

↑

NOTE: Always order by current part number