

# PARTS LIST

EFFECTIVE DATE	MODEL NUMBER	PRODUCT GROUP
JANUARY 1995	VF-305CN VC-305C3N C-305C3N VC-305AN VC-305C2N REVISED	FAN

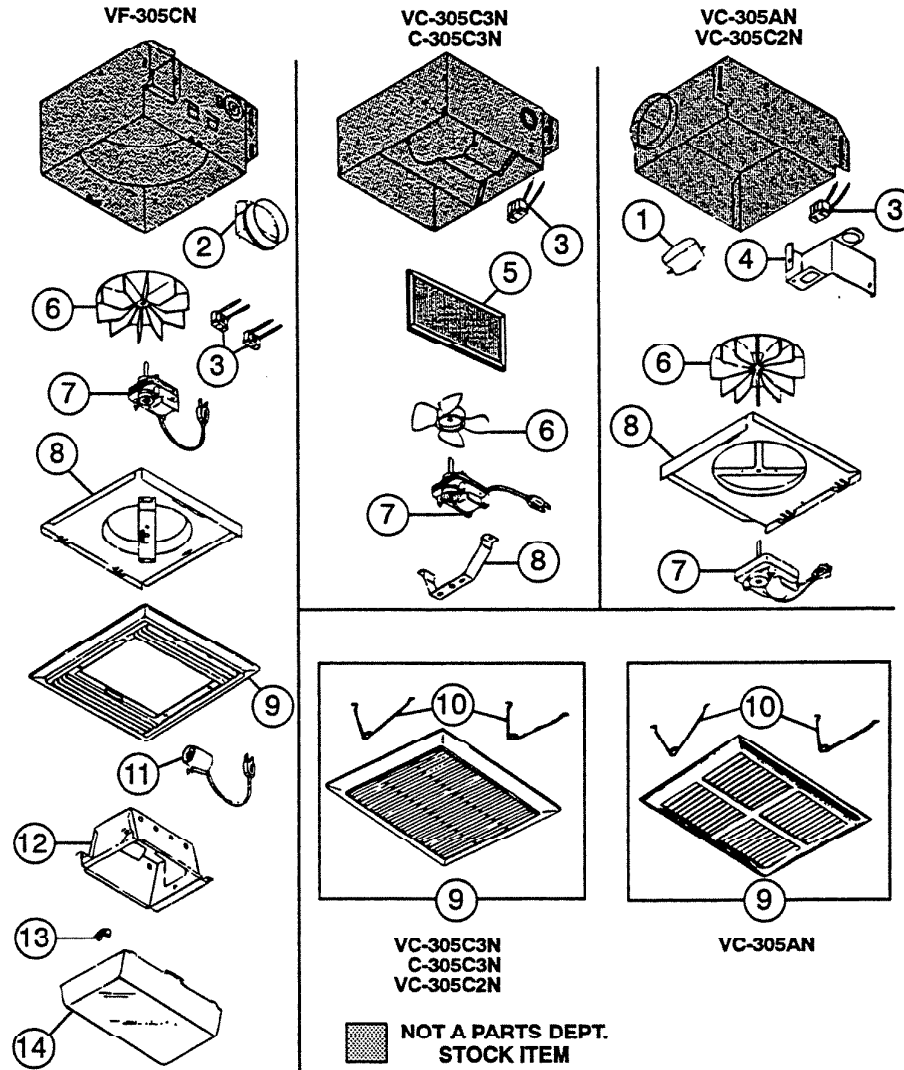

REF.	ORIGINAL PART NO.	*PART DESCRIPTION	MODEL USED ON	CURRENT REPLACEMENT PART NO.
1	29865	LOUVER	VC-305AN VC-305C2N	29865-000
2	53697	DUCT ADAPTOR	VF-305CN	30652-000
3	10034	RECEPTACLE (1)	All Models	10034-000
(PLEASE SEE OTHER SIDE)				

# NuTone

NuTone  
Attn: Parts Department  
Madison & Red Bank Rds.  
Cincinnati, OH 45227-1599  
Phone: (513) 527-5426  
Fax: (513) 527-5173

↑

**NOTE: Always order by current part number**

REF.	ORIGINAL PART NO	*PART DESCRIPTION	MODEL USED ON	CURRENT REPLACEMENT PART NO.
4	29864	OUTLET BOX	VC-305AN VC-305C2N	29864-000
5	34705	CARBON FILTER	VC-305C3N C-305C3N	34705-000
6	68920	IMPELLER W/PUSH NUT	VF-305CN VC-305AN VC-305C2N	68920-000
	68030		VC-305C3N C-305C3N	65934-000
7	65878	MOTOR	VF-305CN	65878-000
	68029		VC-305C3N C-305C3N	68029-000
	34484		VC-305AN VC-305C2N	34484-000
8	K4172	MOTOR BRACKET	VF-305CN	0423A-000
	33383		VC-305C3N C-305C3N	33383-000
	34487		VC-305AN VC-305C2N	34487-000
9	53079	GRILLE — W/SPRINGS IF USED	VC-305CN	53079-000
	53098		VC-305C3N C-305C3N VC-305C2N	53098-000
	32884		VC-305AN	32884-000
10	0442A	SPRING SET (2)	VC-305C3N C-305C3N VC-305AN VC-305C2N	0442A-000
11	33600	LAMP SOCKET	VF-305CN	33600-000
12	33359	REFLECTOR		33359-000
13	16133	WING NUT		16133-000
14	65776	LENS		65776-000

↑

**NOTE: Always order by current part number**