

PARTS LIST

MODEL	V42MD, PD, GD & VG242MD, PD, GD
EFFECTIVE DATE	Bathroom Cabinets January 1, 1972

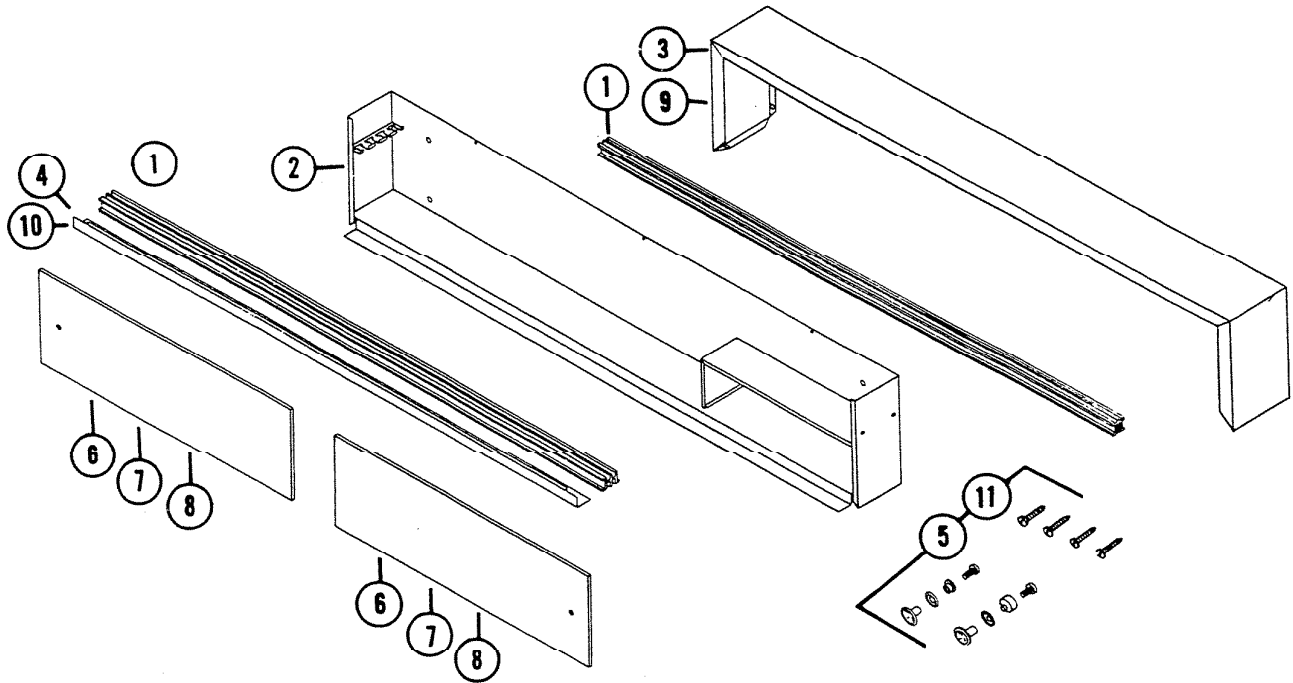

REF.	PART NO.	* Part used on other models.	NOMENCLATURE
<u>COMMON PARTS FOR V42MD, PD, GD</u>			
1	90438		Track for Top or Bottom
2	90435		Body Assy. W/Toothbrush Holder
3	92301		Frame Top/End
4	90440		Frame Bottom
5	90353		Hardware Set
<u>MODEL V42MD and VG242MD</u>			
6	90444		Door - Mirror for Left or Right Hand
<u>MODEL V42PD and VG242PD</u>			
7	90447		Door - Plastic for Left or Right Hand
<u>MODEL V42GD and VG242GD</u>			
8	90449		Door - Glass for Left or Right Hand - Early Models
<u>COMMON PARTS FOR VG242MD, PD, GD</u>			
1	90438		Track for Top or Bottom
2	90435		Body Assy. W/Toothbrush Holder
9	92306		Frame Top/End
10	90442		Frame Bottom
11	90357		Hardware Set

NuTone Division

Order Parts From: Parts Department c/o
NuTone
Madison & Red Bank Road
Cincinnati, Ohio 45227