

# PARTS LIST

EFFECTIVE DATE	MODEL	PRODUCT GROUP
JAN. 1990	SH-2000 SH-2000N SH-2000SO 24" 30" 36" BLACK/WHITE NEW	HOOD

IMPORTANT: Determine Model Series;  
SH-2000 or SH-2000N  
See NOTE on Last Page.

 NOT A PARTS DEPT.  
STOCK ITEM

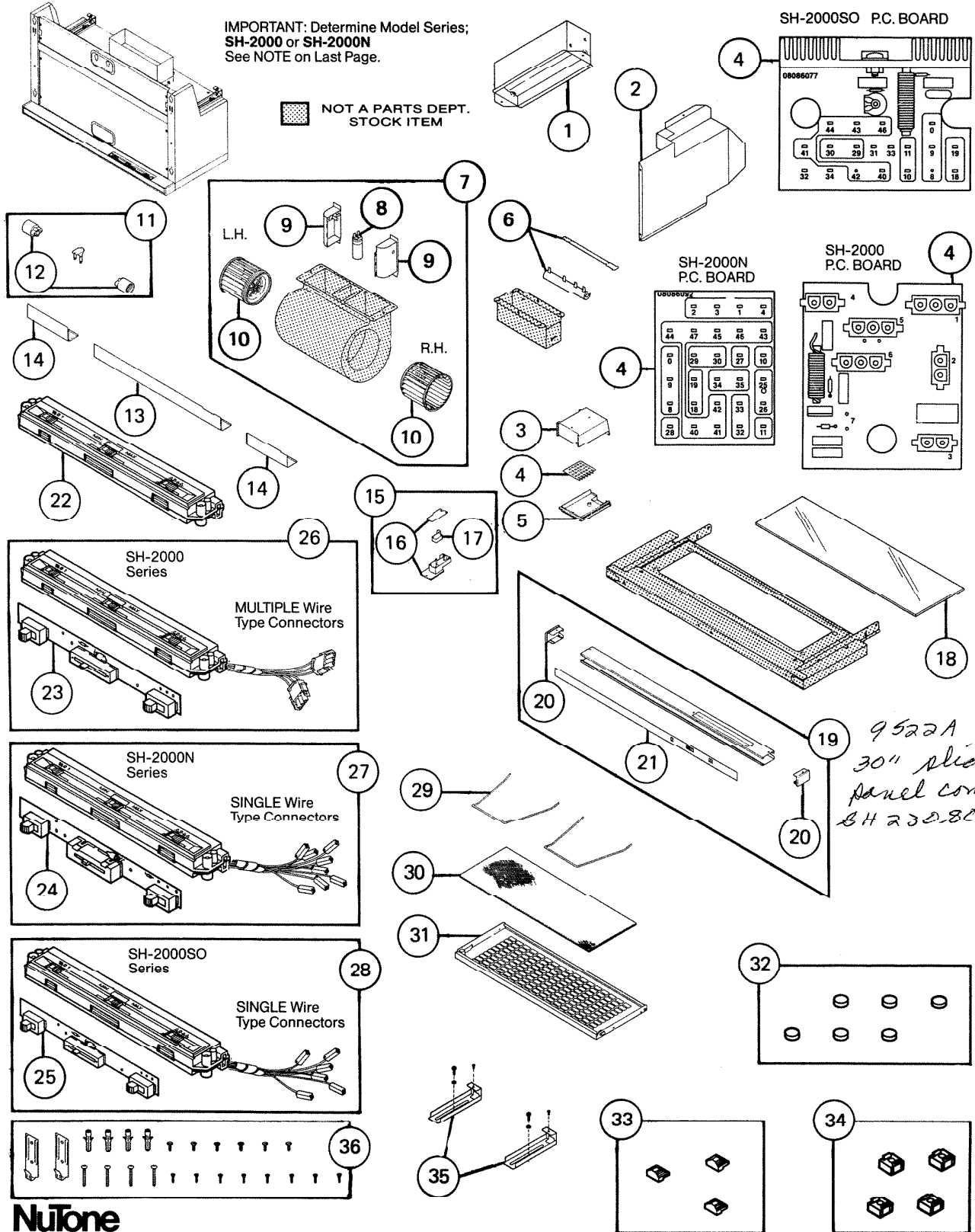

REF.	ORIGINAL PART NO.	*PART DESCRIPTION			MODEL USED ON	CURRENT REPLACEMENT PART NO.
1	9484A	DUCT AND DAMPER ASSEMBLY				9484A-000
2	9515A	ELECTRICAL BOX SIDE PROTECTION			ALL MODELS	9515A-000
3	9582A	ELECTRICAL BOX				9582A-000
4	9313A	P.C. BOARD ASSY.	Board No. 682	SH-2000 Series	9313A-000	
	9510A		Board No. 08086092	SH-2000N Series	9510A-000	
	9511A		Board No. 08086077	SH-2000SO Series	9511A-000	
5	9583A	ELECTRICAL BOX COVER			ALL MODELS	9583A-000
6	2914A	RESISTOR W/PIN			SH-2000N Series	2914A-000
7	9613A	BLOWER AND MOTOR ASSEMBLY— Not Used On "SO" Models			SH-2000 Series	9613A-000
	9614A				SH-2000N Series	9614A-000
8	9508A	CAPACITOR—4MF—Not Used on SO Models				9508A-000
9	9507A	CAPACITOR BOX ASSY.—Not Used on SO Models			SH-2000 Series and SH-2000N Series	9507A-000
10	9519A	BLOWER WHEEL W/NUT— Not Used on SO Models	L.H.	SH-2000N Series	9519A-000	
	9520A		R.H.		9520A-000	
11	9615A	LAMP HOLDER ASSEMBLY—w/Wire Harness			SH-2000 Series	9615A-000
	9616A				SH-2000N and SH-2000SO Series	9616A-000
12	9587A	LAMP HOLDER (1)—2 Req.			ALL MODELS	9587A-000
13	9493A	LENS	19 <sup>1</sup> / <sub>16</sub> "	24 inch MODELS	9493A-000	
	9497A		19 <sup>7</sup> / <sub>16</sub> "	30 and 36 inch MODELS	9497A-000	
14	9494A	LENS EXTENSION SET—Not used on 24" Models			30 inch MODELS	9494A-000
	9495A				36 inch MODELS	9495A-000
15	9499A	MICRO SWITCH AND BOX ASSY. W/wire harness	With MULTIPLE Wire Type Connectors	Black	SH-2000 Series	9499A-000
	White			9589A-000		
	9662A		With SINGLE Wire Type Connectors	Black	SH-2000N and SH-2000SO Series	9662A-000
	9590A			White		9590A-000
16	9591A	BOX ASSEMBLY—wo/Micro Switch		Black	ALL MODELS	9591A-000
	9592A			White		9592A-000
17	9593A	MICRO SWITCH			ALL MODELS	9593A-000

↑

**NOTE: Always order by current part number.**

REF.	ORIGINAL PART NO.	*PART DESCRIPTION	MODEL USED ON	CURRENT REPLACEMENT PART NO.
18	9502A	TOP GLASS	19 <sup>3</sup> / <sub>8</sub> x 5 <sup>5</sup> / <sub>8</sub> "	24 inch MODELS <b>9502A-000</b>
	9503A		25 <sup>3</sup> / <sub>8</sub> x 5 <sup>5</sup> / <sub>8</sub> "	30 inch MODELS <b>9503A-000</b>
	9504A		31 <sup>3</sup> / <sub>8</sub> x 5 <sup>5</sup> / <sub>8</sub> "	36 inch MODELS <b>9504A-000</b>
19	9636A	FRONT PANEL ASSEMBLY wo/Switches	BLACK	24 inch MODELS <b>9636A-000</b>
	9622A			30 inch MODELS <b>9622A-000</b>
	9619A			36 inch MODELS <b>9619A-000</b>
	9637A		WHITE	24 INCH MODELS <b>9637A-000</b>
	9623A			30 inch MODELS <b>9623A-000</b>
	9653A			36 inch MODELS <b>9653A-000</b>
20	9500A	FRONT PANEL SIDE SET— Left and Right	BLACK	... ALL MODELS ... <b>9500A-000</b>
	9625A		WHITE	<b>9625A-000</b>
21	9512A	FRONT PLEXIGLAS PANEL	BLACK	24 inch MODELS <b>9512A-000</b>
	9513A			30 inch MODELS <b>9513A-000</b>
	9514A			36 inch MODELS <b>9514A-000</b>
	9638A		WHITE	24 inch MODELS <b>9638A-000</b>
	9624A			30 inch MODELS <b>9624A-000</b>
	9639A			36 inch MODELS <b>9639A-000</b>
22	9630A	SWITCH HOUSING ASSEMBLY—only	BLACK	... ALL MODELS ... <b>9630A-000</b>
	9631A		WHITE	<b>9631A-000</b>
23	9574A	SH-2000 Series P.C. BOARD and SWITCH ASSEMBLY	SH-2000 Series	<b>9574A-000</b>
24	9575A	SH-2000N Series P.C. BOARD and SWITCH ASSEMBLY	SH-2000N Series	<b>9575A-000</b>
25	9640A	SH-2000SO Series P.C. BOARD and SWITCH ASSEMBLY	SH-2000SO Series	<b>9640A-000</b>
26	9626A	SH-2000 Series P.C. BOARD and SWITCH HOUSING ASSEMBLY W/Wire Harness	BLACK	... SH-2000 ... Series <b>9626A-000</b>
	9627A		WHITE	<b>9627A-000</b>
27	9660A	SH-2000N Series P.C. BOARD and SWITCH HOUSING ASSEMBLY W/Wire Harness	BLACK	... SH-2000N ... Series <b>9660A-000</b>
	9628A		WHITE	<b>9628A-000</b>
28	9661A	SH-2000SO Series P.C. BOARD and SWITCH HOUSING ASSEMBLY W/Wire Harness	BLACK	... SH-2000SO ... Series <b>9661A-000</b>
	9629A		WHITE	<b>9629A-000</b>
29	9489A	WIRE STOP (1)—Filter	ALL MODELS	<b>9489A-000</b>

↑

**NOTE: Always order by current part number.**

REF.	ORIGINAL PART NO.	*PART DESCRIPTION	MODEL USED ON	CURRENT REPLACEMENT PART NO.	
30	9486A	GREASE FILTER	17½ x 6½"	24 inch MODELS 9486A-000	
	9487A		23½ x 6½"	30 inch MODELS 9487A-000	
	9488A		29½ x 6½"	36 inch MODELS 9488A-000	
31	9490A	GRILLE ASSEMBLY w/clips	24"	BLACK 24 inch MODELS 9490A-000	
	9594A			WHITE 24 inch MODELS 9594A-000	
	9491A		30"	BLACK 30 inch MODELS 9491A-000	
	9617A			WHITE 30 inch MODELS 9617A-000	
	9492A		36"	BLACK 36 inch MODELS 9492A-000	
	9618A			WHITE 36 inch MODELS 9618A-000	
32	9505A	ADHESIVE DISK SET—(6)	ALL MODELS	2913A-000	
33	9501A	SWITCH BUTTON SET—(3)	BLACK	ALL MODELS	9501A-000
	9571A		WHITE		9571A-000
34	9606A	NUT PLATE SET—(4)—Used for Mounting		2912A-000	
35	9485A	TOP STIRRUP ASSEMBLY—Used for Mounting	ALL MODELS	9485A-000	
36	9525A	HARDWARE BAG—Mounting		9525A-000	

**NOTE:** SH-2000 use a solid-state speed control located on the SH-2000 P.C. board reference No. 4  
SH-2000N use the large green resistor reference No. 6 for speed control.

To locate the green resistor first remove the filter panel. The resistor is located under the resistor cover to the right side of the blower housing.

SO models, shell only, use exterior mounted ventilators RF-1N; WF-1N; RF-35 or WF-35.

**NOTE:** Always order by current part number.

