

PARTS LIST

EFFECTIVE DATE	MODEL	PRODUCT GROUP
JULY 1977	RF-69 NEW	FAN

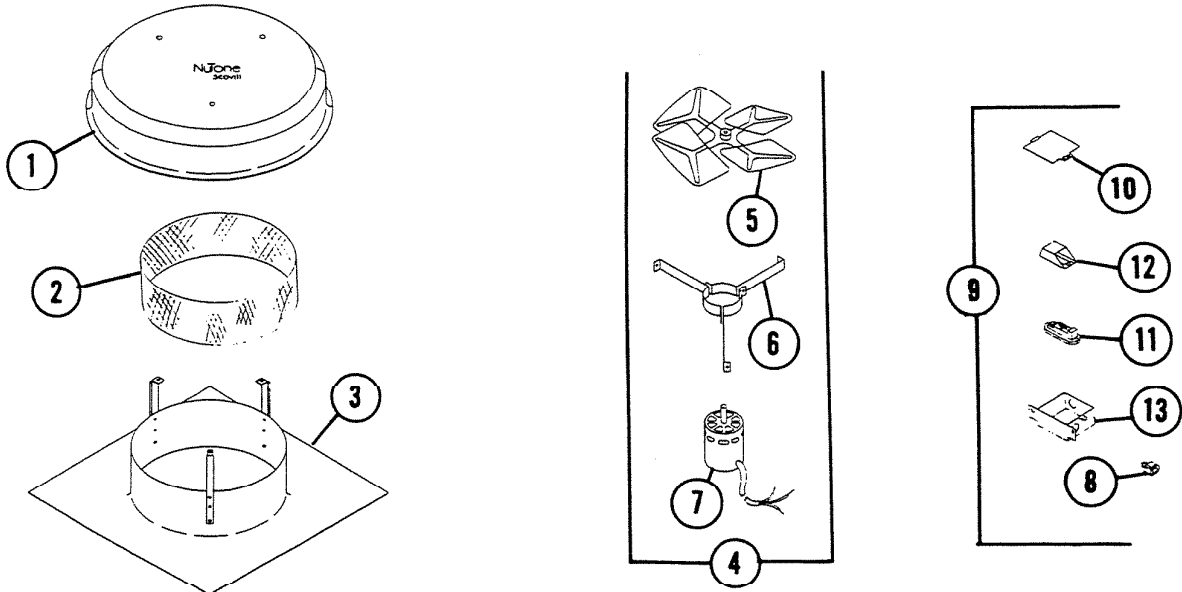

RAIN SHIELD 1047A-000

REF.	ORIGINAL PART NO.	* PART DESCRIPTION	MODEL USED ON	CURRENT REPLACEMENT PART NO.
1	67184-000	COVER	RF-69	67184-000
2	67174-000	BIRD GUARD	RF-69	67174-000
3	1272A-000	FLASH PLATE ASSY	RF-69	1272A-000
4	1280A-000	"B" UNIT (MOTOR, BLADE, BRKT.)	RF-69	1280A-000
5	67180-000	FAN BLADE	RF-69 / RF-69N	67180-000
6	1279A-000	MOTOR BRKT SET	RF-69	1279A-000
7	67178-000	MOTOR (No. On Data Plate DBZE-005N)	RF-69 / RF-69N	67178-000
8	50446-000	STRAIN RELIEF	RF-69	50446-000
9	64641-000	OUTLET BOX & THERMOSTAT ASSY	RF-69	64641-000
10	64648-000	OUTLET BOX COVER	RF-69	64648-005
11	26693-000	THERMOSTAT RF-69N - 68643-000	RF-69	26693-000
12	26706-000	THERMOSTAT BARRIER	RF-69	26706-000
13	64642-000	OUTLET BOX	RF-69	64642-000
-	13028-000	GROUND SCREW 10-32 x 7/16 type 1 (Not Shown)	RF-69	13028-000

NuTone Division

Order Parts From:
 Parts Department c/o NuTone
 P.O. Box 27 • Cincinnati, Ohio 45227

NOTE: Always order by
 current part number.