

# PARTS LIST

EFFECTIVE DATE	MODEL NUMBER	PRODUCT GROUP
OCTOBER 1994	RF-49, RF-49N REVISED	FAN

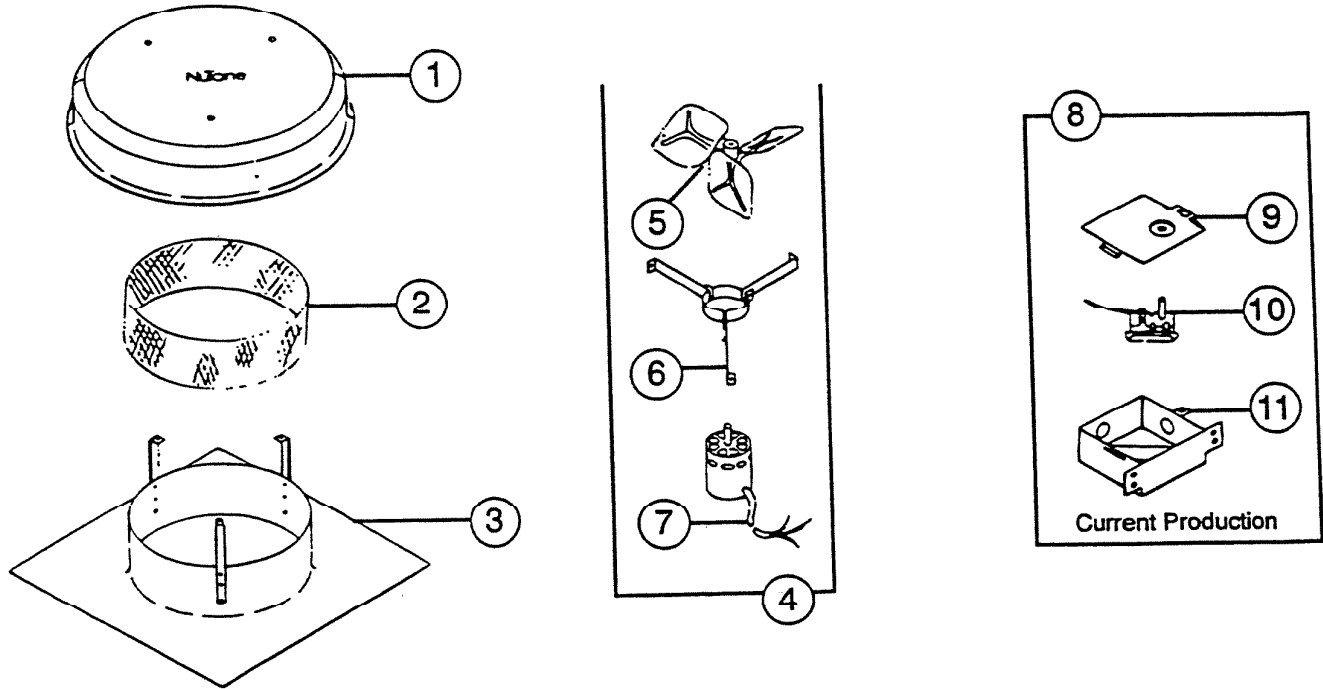

REF.	ORIGINAL PART NO.	*PART DESCRIPTION	MODEL USED ON	CURRENT REPLACEMENT PART NO.
1	67183	COVER	All Models	67183-005
2	67174	BIRD GUARD	All Models	67174-000
3	1275A	FLASH PLATE ASSEMBLY	All Models	1275A-000
4	1276A	"B" UNIT – Motor, Blade, Bracket	All Models	1276A-000
5	67179	FAN BLADE	All Models	67179-000
6	1277A	MOTOR BRACKET SET	All Models	1277A-000
7	67176	MOTOR	All Models	32997-SER
8	64641	OUTLET BOX AND THERMOSTAT ASSEMBLY	All Models	1249A-000
9	64648	OUTLET BOX COVER	All Models	68644-000
10	68643	THERMOSTAT	RF-49N	68643-000
	26693		RF-49	1249A-000
11	64642	OUTLET BOX	All Models	68642-000

# NuTone

NuTone  
 Attn: Parts Department  
 Madison & Red Bank Rds.  
 Cincinnati, OH 45227-1599  
 Phone: (513) 527-5426  
 Fax: (513) 527-5173

↑

**NOTE: Always order by current part number**