

MODELS M-681, M-682, M-684 PARTS PRICE LIST

EFFECTIVE DATE JULY 1, 1965

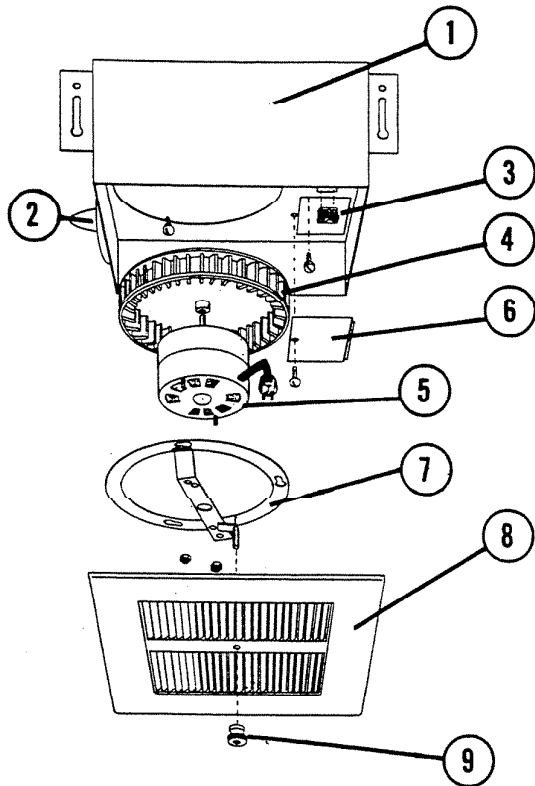

REF. NO.	PART NO.	DESCRIPTION
1	20295	"A" Housing
2	20299	Louver Assy.
*	11464	Rubber Bumper
*	20301	Louver Spring
3	10034	Receptacle
4	20310	Blower Wheel — Model M-682
	20310	Blower Wheel — Model M-684
*	20311	Retaining Ring (For Blower Wheel)
*	17728	Fan Blade — Model M-681
5	19444	Motor — M-682 (No. on Data Plate AJ4170A or AA2A005, CCW Rot.)
*	26729	Motor — M-684 (No. on Data Plate AJ2143A or AA1C077, CCW Rot.)
*	17727	Motor — M-681
6	20302	Outlet Box Cover
7	20304	Motor Mount Assy. (Motor Bracket)
8	16246	Grille
9	14436	Thumb Nut
*	21274	"B" Unit — M-682. (Motor, Bracket, Blower Wheel, Grille and Thumb Nut.)
*	20313	"B" Unit — M-684. (Motor, Bracket, Blower Wheel, Grille and Thumb Nut.)
*	17724	"B" Unit — M-681. (Motor, Bracket, Fan Blade, Grille and Thumb Nut.)

* Items not shown.

INSTALLATION PRECAUTIONS

To achieve the designed performance of this product, observe all requirements set forth in this instruction sheet and all markings appearing on the product . . . otherwise the warranty is voided. Attach housing to joist and adjust front edge of housing to be flush with proposed plaster line. Handle "B" unit carefully to avoid possible damage to alignment of fan.

To insure firm mounting, housing must be fastened through all four holes provided in the mounting bracket.

Remove tape from the louver . . . at the exhaust opening of the housing, to insure unobstructed air flow.

MERCURY FANS ■

Madison and Red Bank Roads
Cincinnati, Ohio 45227