

# PARTS LIST

EFFECTIVE DATE	MODEL NUMBER	PRODUCT GROUP
SEPTEMBER 1994	LA-8 REVISED	CHIME

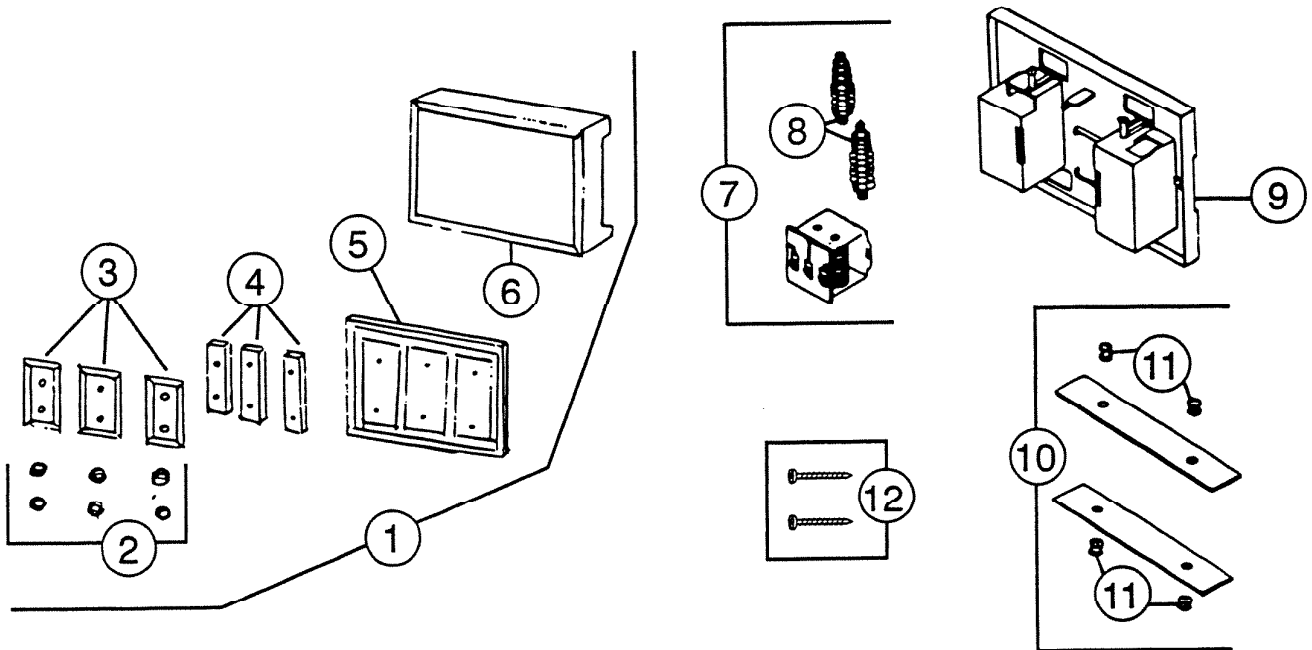

REF.	ORIGINAL PART NO.	*PART DESCRIPTION	MODEL USED ON	CURRENT REPLACEMENT PART NO.
1	34227	COVER – Complete	LA-8	34227-000
2	34233	KNOB – Brass – 6 Required	LA-8	1226A-000
3	34232	BEVELED GLASS (1) – 3 Required	LA-8	34232-000
4	34231	BRASS STRAP (1) – 3 Required	LA-8	Void - not avail.
5	34226	LITHOGRAPHED FRONT PLATE	LA-8	34226-000
6	34228	COVER ASSEMBLY	LA-8	34228-000
7	1133A	POWER UNIT WITH PLUNGERS	LA-8	1133A-000
8	69550	PLUNGER SET	LA-8	69550-000
9	63561	BASEPLATE ONLY (Plastic)	LA-8	63561-000
10	69669	REED SET – 1 - Top, 1 - Bottom	LA-8	69669-000
11	69683	GROMMET SET – 6	LA-8	69683-000
12	65364	ENVELOPE ASSEMBLY (Mtg. Screws)	LA-8	65364-000

# NuTone

NuTone  
 Attn: Parts Department  
 Madison & Red Bank Rds.  
 Cincinnati, OH 45227-1599  
 Phone: (513) 527-5426  
 Fax: (513) 527-5173

↑  
**NOTE: Always order by current part number**