

PARTS LIST

EFFECTIVE DATE	MODEL	PRODUCT GROUP
FEBRUARY 1980	LA-22 NEW	CHIME

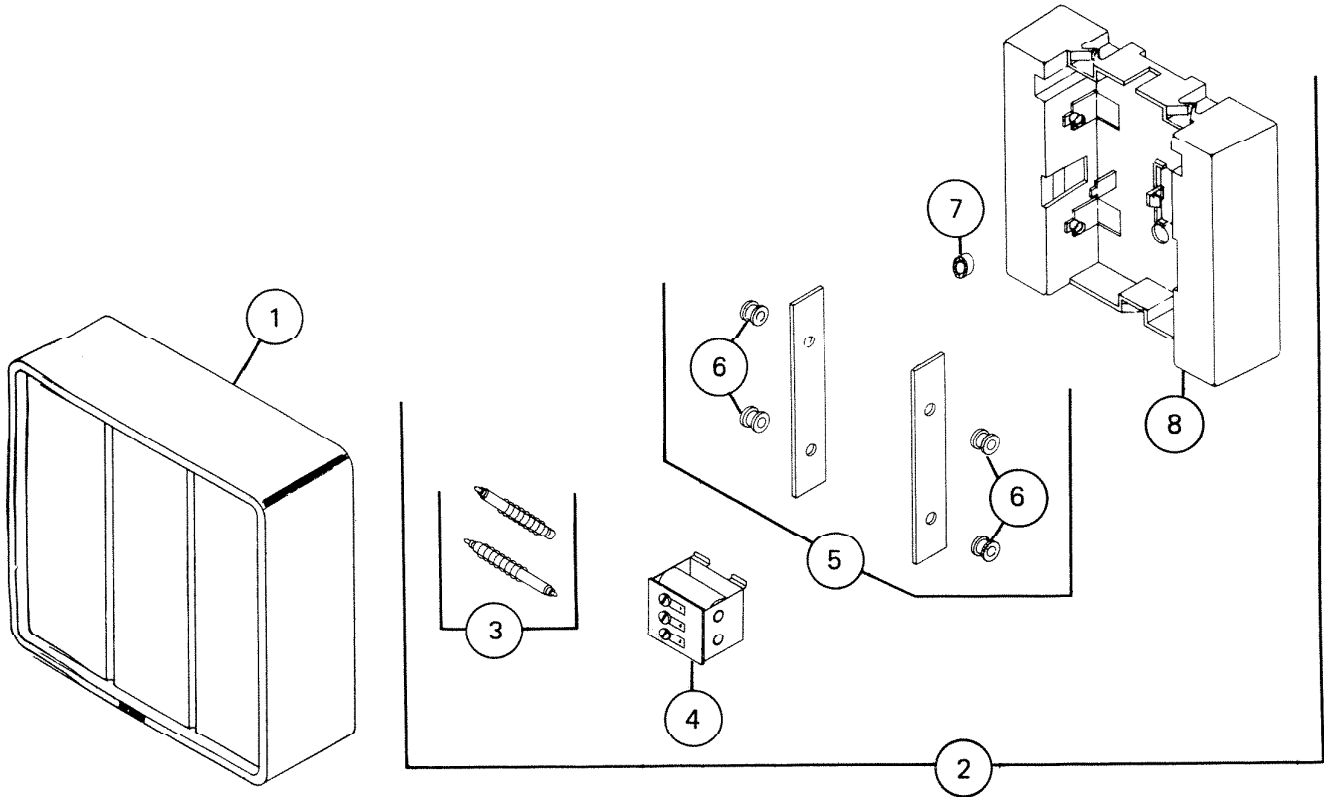

REF.	ORIGINAL PART NO.	* PART DESCRIPTION	MODEL USED ON	CURRENT REPLACEMENT PART NO.
1	68843	COVER ASSEMBLY	LA-22	68843-000
	68844			68844-000
2	65272	MECHANISM ASSEMBLY	LA-22	65272-000
3	69550	PLUNGER SET	LA-22	69550-000
4	63562	POWER UNIT ASSEMBLY	LA-22	63562-000
5	1122A	REED SET W/GROMMETS	LA-22	1122A-000
6	02923	GROMMET SET - 6	LA-22	69683-000
7	67274	RUBBER BUMPER	LA-22	67274-000
8	66439	BASEPLATE ASSEMBLY	LA-22	66439-000
----	65364	ENVELOPE ASSY. - MTG. SCREWS - Not Shown	LA-22	65364-000

NuTone

NOTE: Always order by current part number.