

# PARTS LIST

EFFECTIVE DATE	MODEL NUMBER	PRODUCT GROUP
SEPTEMBER 1994	L-43, LA-43 OBSOLETE REVISED	CHIME

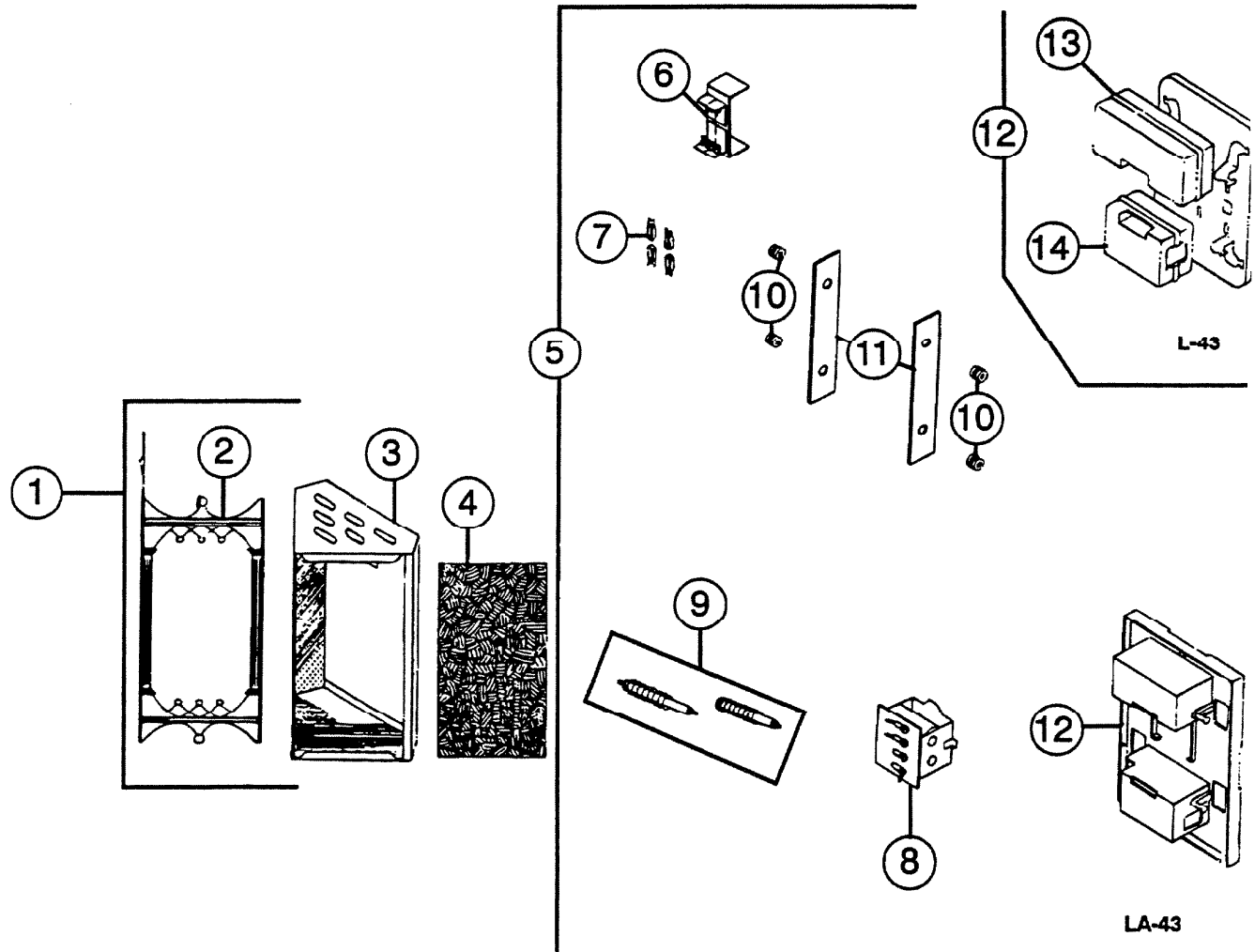

REF.	ORIGINAL PART NO.	*PART DESCRIPTION	MODEL USED ON	CURRENT REPLACEMENT PART NO.
1	9544	COVER ASSEMBLY – Complete	All Models	Void - not avail.
2	9548	COVER PANEL	All Models	Void - not avail.
3	9545	COVER FRAME ASSEMBLY	All Models	Void - not avail.
4	9549	COVER WINDOW	All Models	Void - not avail.
(PLEASE SEE OTHER SIDE)				

# NuTone

NuTone  
 Attn: Parts Department  
 Madison & Red Bank Rds.  
 Cincinnati, OH 45227-1599  
 Phone: (513) 527-5426  
 Fax: (513) 527-5173

↑

**NOTE: Always order by current part number**

REF.	ORIGINAL PART NO.	*PART DESCRIPTION	MODEL USED ON	CURRENT REPLACEMENT PART NO.
5	9535, 63843	MECHANISM ASSEMBLY	All Models	Void - not avail.
6	9539	LAMP HOLDER & BRACKET ASSEMBLY	L-43	Void - not avail.
	63846		LA-43	Void - not avail.
7	31450	PILOT LAMP	Production 1969/1980	Void - not avail.
			Production 1980/1983	39330-000
8	9463	POWER UNIT ASSEMBLY	L-43	Void - not avail.
	63844		LA-43	Void - not avail.
9	69557	PLUNGER SET	L-43	Void - not avail.
	69676		LA-43	69550-000
10	2923, 69683	GROMMET SET - 6	All Models	69683-000
11	69616	REED SET	All Models	69669-000
12	6727	BASEPLATE	L-43	Void - not avail.
	63561		LA-43	63561-000
13	9536	TOP RESONATOR ASSEMBLY	L-43	Void - not avail.
14	9458	BOTTOM RESONATOR ASSEMBLY	L-43	Void - not avail.
-	2747	MOUNTING SCREW SET (Not Shown)	All Models	65364-000

↑

NOTE: Always order by current part number