

PARTS LIST

EFFECTIVE DATE	MODEL NUMBER	PRODUCT GROUP
SEPTEMBER 1994	LB-46, K-46 REVISED	CHIME

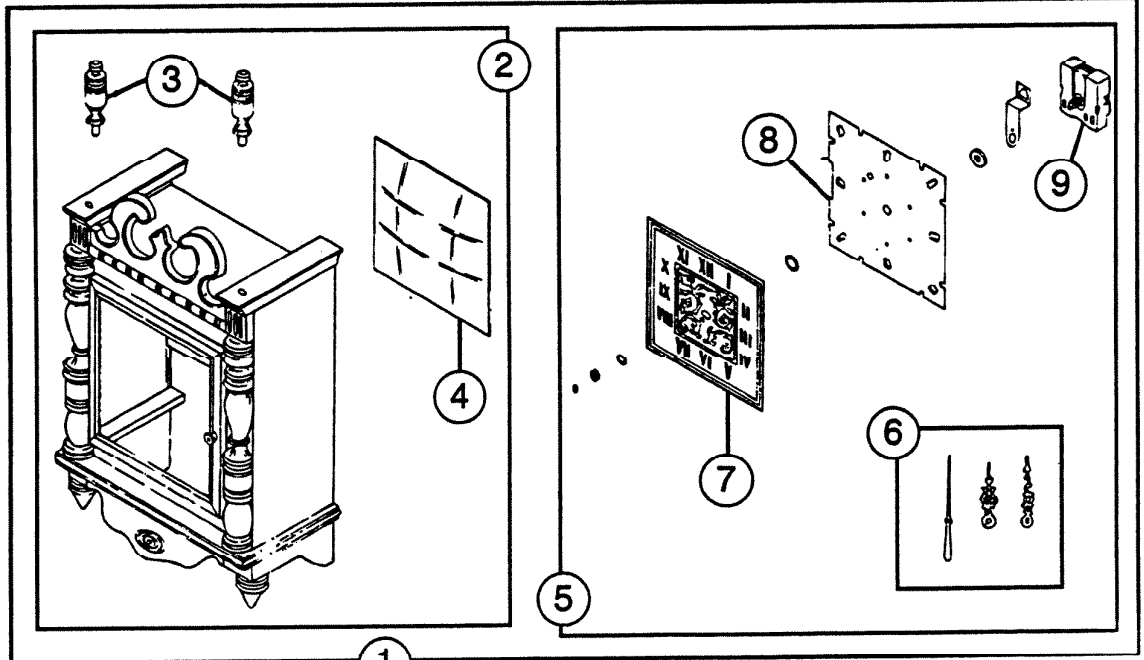

IMPORTANT
 Model K-46 Parts
 Ref. No.'s 4, 5, 10 ONLY
 No other parts are available

LB-46 chime uses transformer
 Model 105-T (16 Volt, 15 Watt)

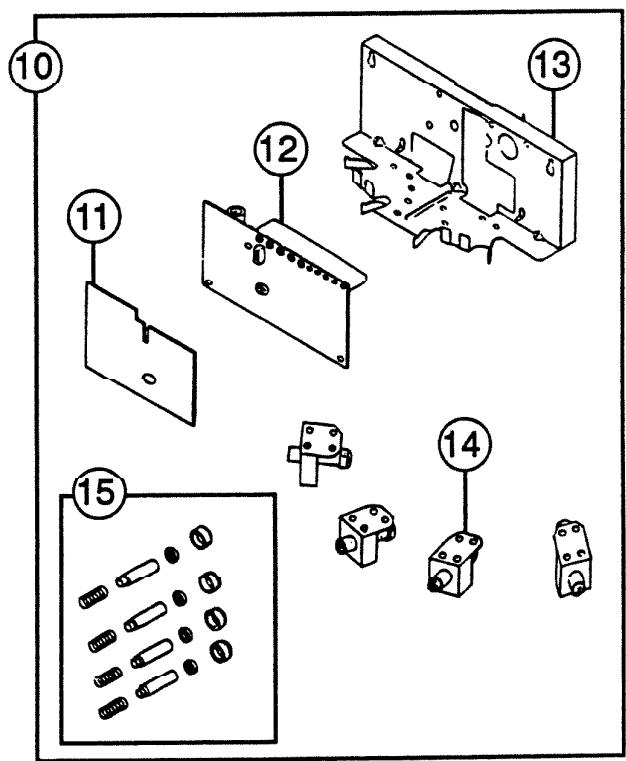

NuTone

NuTone
 Attn: Parts Department
 Madison & Red Bank Rds.
 Cincinnati, OH 45227-1599
 Phone: (513) 527-5426
 Fax: (513) 527-5173

REF.	ORIGINAL PART NO.	*PART DESCRIPTION	MODEL USED ON	CURRENT REPLACEMENT PART NO.
1	37972	CABINET – Complete with Clock	All Models	37972-000
2	1954A	CABINET ASSEMBLY	All Models	1954A-000
3	58469	FINAL SET	All Models	1956A-000
4	05793	CLOCK CRYSTAL	All Models	05793-000
5	37978	CLOCK MOUNTING PLATE ASSEMBLY	LB-46	37978-000
	1960A		K-46	1960A-000
6	1955A	HAND SET – with Knurled Nut	All Models	1955A-000
7	37980	CLOCK FACE	All Models	37980-000
8	06086	CLOCK MOUNTING PLATE	All Models	06086-005
9	37979	CLOCK MECHANISM – with Hands and all Nuts	All Models	37979-000
10	37970	MECHANISM ASSEMBLY – See Note * For Modl K-46	All Models	1236A-000
11	37989	CARD – Information	All Models	1957A-000
12	30458	TERMINAL P.C. BOARD ASSEMBLY	All Models	1237AREB
13	30705	CHASSIS	All Models	30705-005
14	08136	POWER UNIT ASSEMBLY – with Plunger, Spring, Cap	All Models	08135-000
15	69581	PLUNGER SET –4	All Models	69581-000
16	H9855	TUBE SET	All Models	H9855-000
17	H9857	TUBE NO. 1 – 43 ²⁷ / ₃₂ "	All Models	H9857-000
18	H9858	TUBE NO. 2 – 37 ²⁷ / ₃₂ "	All Models	H9858-000
19	H9859	TUBE NO. 3 – 35 ¹⁹ / ₃₂ "	All Models	H9859-000
20	H9860	TUBE NO. 4 – 33 ¹ / ₄ "	All Models	H9860-000
21	H9863	TUBE HANGER SET – 4	All Models	1958A-000

* NOTE: Transformer on Model K-46 must be changed to MODEL 105-T (16 Volt, 15 Watt) when updating to Chime Mechanism P/N 1236A-000.

NOTE: Always order by current part number

