

# NUTONE, INC.

## Parts Price List

EFFECTIVE DATE:  
Jan. 1, 1965

NEW  
Model No. F-500

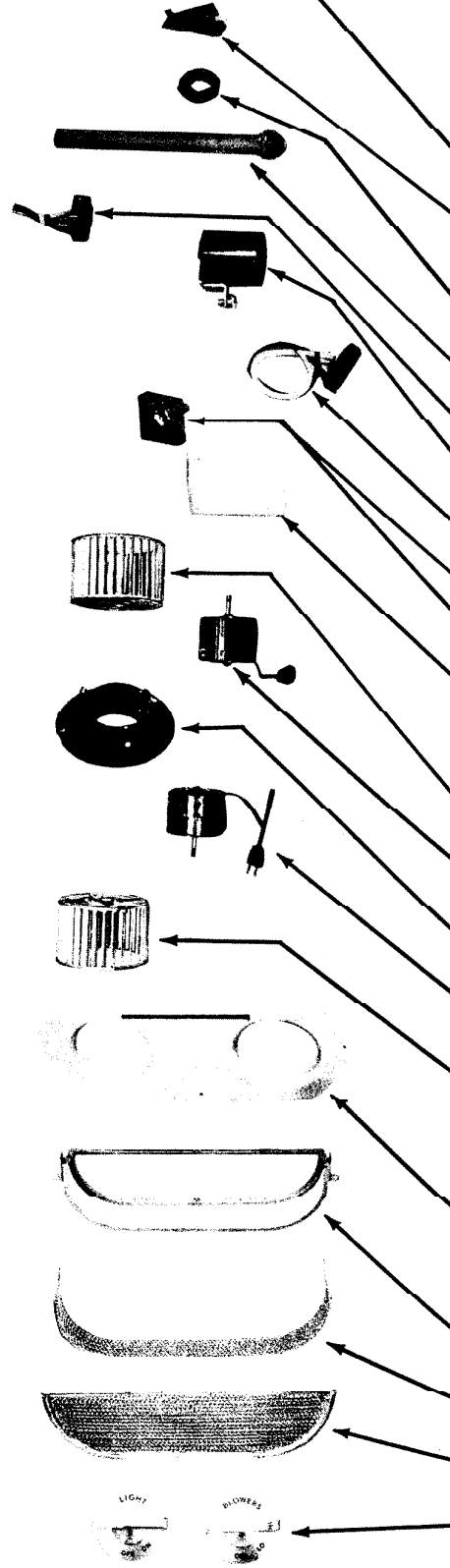
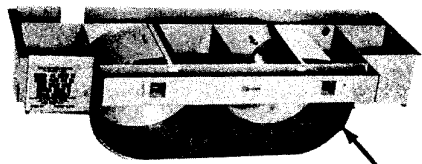

PART NO.	PART DESCRIPTION	LIST PRICE
26401	Completely Wired "A" Unit Assembly with Switches (Not Shown)	
13567	Housing Assembly	
13592	Center Bracket	
14380	Cover Plate (Not Shown)	
12594	Grommet	
13595	Wiring tube w/nuts	
17473	Male Plug	
14979	Lamp Socket (1)	
10034	Receptacle (1)	
17482	Switch (2 Pos. for Light)	
13616	Switch (3 Pos. for Fan)	
17628	Lens (1)	
13630	R.H. "B" unit - Motor, Blower Wheel, Sleeve Assy. (Not Shown)	
13654	Blower Wheel R.H.	
13663	Motor R. H. (C.W. Rotation) No. on Data Plate AK4K37A or 118-185	
13641	Motor sleeve complete for L or R side	
13664	Motor L. H. (C.C.W. Rotation) No. on data plate AK4K38A or 118-186	
13655	Blower Wheel L.H.	
13631	L.H. "B" unit - Motor, Blower Wheel, & sleeve assy. Not Shown	
13658	Venturi Plate Assembly	
26407	Filter Frame Complete (Includes Part Nos. 26416 & 26417.)	
26409	Filter Frame Assembly (Alum.)	
26416	Bottom Filter	
26417	Front Filter	
26421	Envelope Assy. (Knob Set 2)	

69109

also F-500W knobs

PRICES SUBJECT TO  
CHANGE WITHOUT NOTICE

**Order Parts From:**

**NUTONE, INC.**  
P. O. BOX 27  
Cincinnati, Ohio 45227

Printed in the U.S.A.