

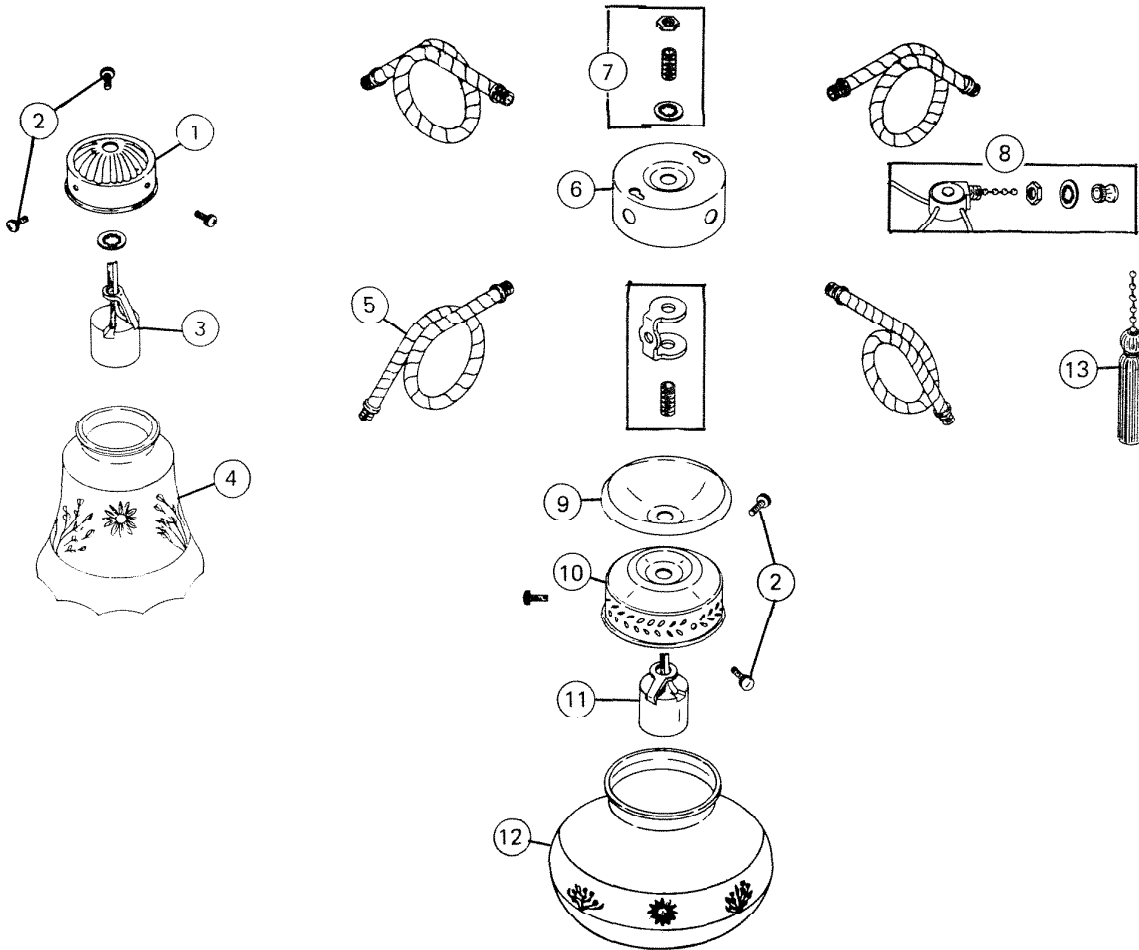

PARTS LIST

EFFECTIVE DATE	MODEL	PRODUCT GROUP
JANUARY 1985	EFLK-5AB, BR "DUBLIN" NEW	PADDIE FAN



REF.	ORIGINAL PART NO.	* PART DESCRIPTION	MODEL USED ON	CURRENT REPLACEMENT PART NO.
1	H6279	SOCKET HOLDER	EFLK-5AB EFLK-5BR	6527A-HAB 6527A-HPB
2	H0989	THUMB SCREW SET (3)	EFLK-5 AB, BR	1364A-000
3	6889A	LAMP SOCKET - ARM	EFLK-5 AB, BR	6889A-000
4	6885A	SHADE - 4 REQUIRED	EFLK-5 AB, BR	6885A-000
5	6887A	ARM ASSEMBLY	EFLK-5AB EFLK-5BR	6887A-027 6887A-048
(PLEASE SEE OTHER SIDE)				

REF	ORIGINAL PART NO	* PART DESCRIPTION	MODEL USED ON	CURRENT REPLACEMENT PART NO
6	6469A	LAMP BODY	EFLK-5AB	6469A-HAB
			EFLK-5BR	6469A-HPB
7	1375A	HARDWARE ASSEMBLY	EFLK-5 AB, BR	1375A-000
8	H6249	SWITCH - PULL	EFLK-5 AB, BR	6537A-000
9	6470A	BOTTOM	EFLK-5AB	6470A-HAB
			EFLK-5BR	6470A-HPB
10	H7664	LAMPHOLDER - CENTER	EFLK-5AB	6530A-HAB
			EFLK-5BR	6530A-HPB
11	H6230	LAMPSOCKET - CENTER	EFLK-5 AB, BR	6529A-000
12	6888A	SHADE - CENTER	EFLK-5 AB, BR	6888A-000
13	L6639	TASSEL	EFLK-5 AB, BR	L6639-000
				 NOTE: Always order by current part number.