

PARTS LIST

EFFECTIVE DATE	MODEL	PRODUCT GROUP
FEBRUARY 1977	DT-22 DT-23	BATH CABINETS

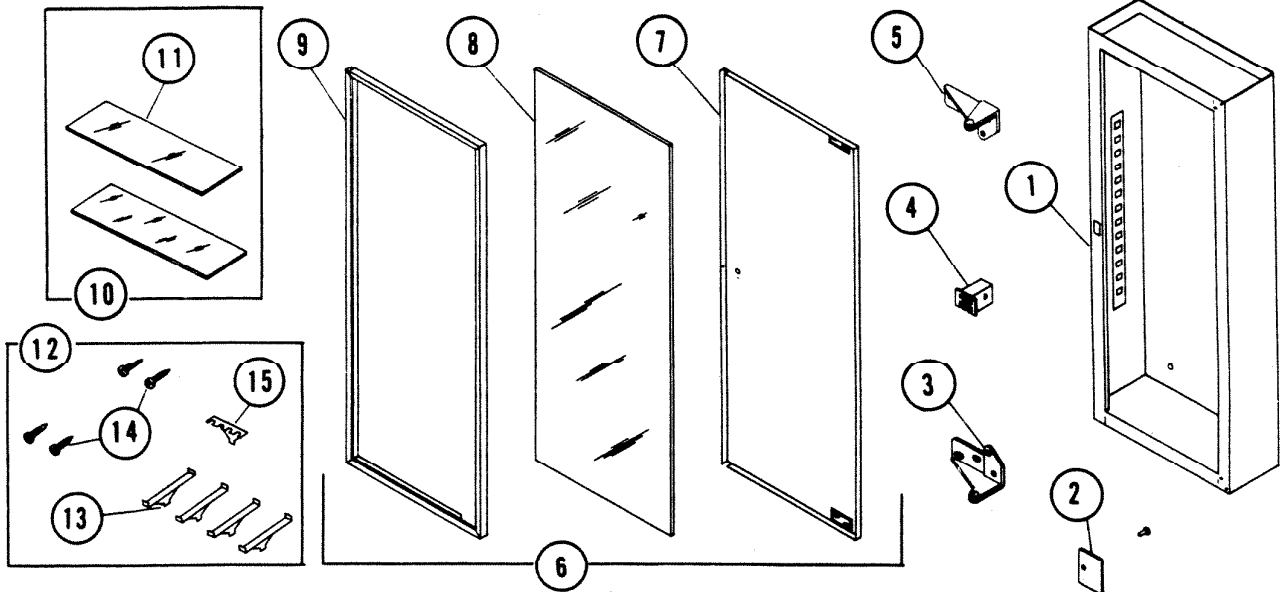

REF	ORIGINAL PART NO.	PART DESCRIPTION		MODEL USED ON	CURRENT REPLACEMENT PART NO.
1	94187	Body Assy.		DT-22	94187-206
	94188			DT-23	94188-206
2	92150	Striker Plate		DT-22 DT-23	92150-000
3	94212	L. H. Hinge		DT-22 DT-23	94212-000
4	90916	Catch - Magnetic		DT-22 DT-23	90916-000
5	94211	R. H. Hinge		DT-22 DT-23	94211-000
6	94193	Door Assy.		DT-22	94193-000
	94210			DT-23	94210-000
7	94194	Door Back		DT-23	94194-206
	94195			DT-23	94195-206
8	94198	Mirror	8" x 28"	DT-22	94198-000
	94199		11" x 28"	DT-23	94199-000
Please See Other Side					

NuTone

Order Parts From:
Parts Department c/o NuTone
 P.O. Box 27 • Cincinnati, Ohio 45227

↑

NOTE Always order by current part number

C.P. DT-22, DT 23 BATH CABINETS

P/N	PART NO.	PART DESCRIPTION		MODEL	PART NO.
9	94206	Frame		DT-22	94206-000
	94207			DT-23	94207-000
10	94214	Shelf Bundle (2)		DT-22	94214-000
	93368			DT-23	93368-000
11	90922	Shelf (1)	3-5/16" x 7 3/4"	DT-22	90922-000
	90941		3-5/16" x 10 3/4"	DT-23	90941-000
12	92266	Hardware Set		DT-22 DT-23	92266-000
13	90589	Shelf Support (1) 4-Required		DT-22 DT-23	90589-000
14	69781	Screw Mtg. Set		DT-22 DT-23	69781-000
15	92264	Toothbrush Holder		DT-22 DT-23	92264-000