

PARTS LIST

EFFECTIVE DATE	MODEL	PRODUCT GROUP
JANUARY 1985	DL-590 NEW	BATH LIGHTING

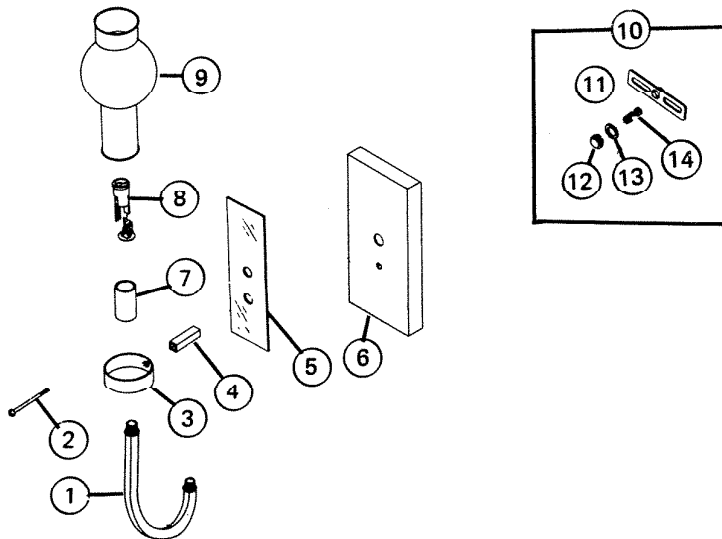

REF.	ORIGINAL PART NO.	* PART DESCRIPTION	MODEL USED ON	CURRENT REPLACEMENT PART NO.
1	57523	LOWER ARM	DL-590	57523-001
2	57527	SCREW - #8-32 X 2 1/4"	DL-590	57527-004
3	57525	GLASS HOLDER	DL-590	57525-017
4	57524	UPPER ARM	DL-590	57524-001
5	57528	MIRROR - BRONZE	DL-590	57528-000
6	57529	BACKPLATE	DL-590	57529-000
7	57526	CANDELABRA CUP	DL-590	57526-H17
8	L6593	CANDELABRA LAMPHOLDER	DL-590	L6593-000
9	57473	SHADE - GLASS	DL-590	57473-000
10	57530	HARDWARE SET	DL-590	57530-000
11	L2406	BAR STRAP - 3 7/8"	DL-590	L2406-000
12	57426	BRACKET CAP	DL-590	57426-001
13	57531	WASHER - NYLON	DL-590	57531-000
14	57425	NIPPLE - 1/8" IPS	DL-590	57425-015

NuTone

PRINTED IN U.S.A.

NOTE: Always order by current part number.