

# PARTS LIST

EFFECTIVE DATE	MODEL	PRODUCT GROUP
APRIL 1985	DL-582 DO,HO NEW	BATH LIGHTING

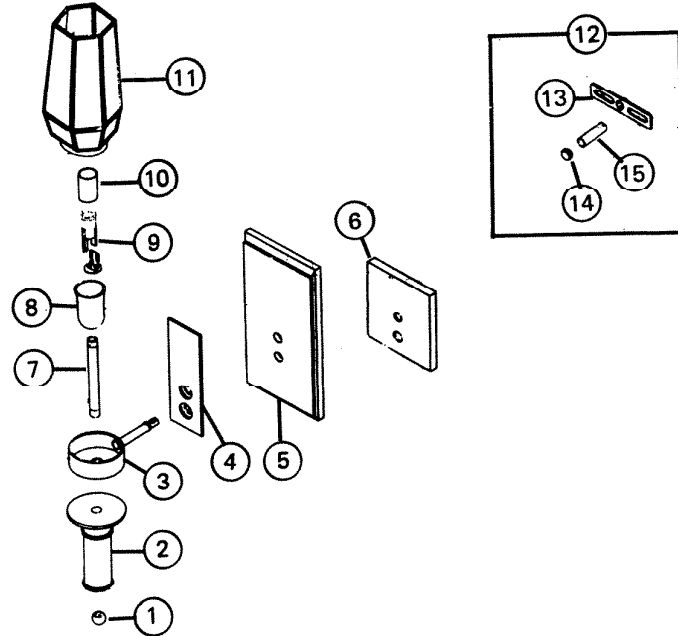

REF.	ORIGINAL PART NO.	* PART DESCRIPTION	MODEL USED ON	CURRENT REPLACEMENT PART NO.	
1	68343	BALL FINIAL	P. B.	DL-582HO	68343-000
	56782		A. B.	DL-582DO	56782-H27
2	57414	SPINDLE	DL-582HO	57414-A08	
	57414		DL-582DO	57414-A12	
3	57411	CUP & WIRING STEM ASSEMBLY	DL-582HO	57411-000	
	57410		DL-582DO	57410-000	
4	57418	BEZEL	DL-582HO	57418-000	
	57417		DL-582DO	57417-000	
5	57462	BACKPLATE	DL-582HO	57462-A08	
	57462		DL-582DO	57462-A12	
6	57419	FLASH BACK	DL-582 HO/DO	57419-000	
7	57415	PIPE NIPPLE - 1/8 IPS"	DL-582 HO/DO	57415-000	
8	57413	CANDLESTICK CUP	P. B.	DL-582HO	57413-H48
	57413		A. B.	DL-582DO	57413-H27
9	L6593	CANDELABRA LAMP HOLDER	DL-582 HO/DO	L6593-000	
(PLEASE SEE OTHER SIDE)					

**NuTone**

NOTE: Always order by current part number.

REF	ORIGINAL PART NO.	* PART DESCRIPTION	MODEL USED ON	CURRENT REPLACEMENT PART NO.	
10	57416	CANDLESTICK	DL-582 HO/DO	57416-000	
11	57421	SHADE - BRASS/GLASS	P.B.	DL-582HO	57421-000
	57420		A.B.	DL-582DO	57420-000
12	57423	HARDWARE ASSEMBLY	DL-582HO	57423-000	
	57422		DL-582DO	57422-000	
13	L2406	BAR STRAP - 3 7/8"	DL-582 HO/DO	L2406-000	
14	57426	BRACKET CAP	P.B.	DL-582HO	57426-048
	57426		A.B.	DL-582DO	57426-027
15	57425	NIPPLE - 1/8" IPS X 1 1/2"	DL-582 HO/DO	57425-015	