

# PARTS LIST

EFFECTIVE DATE	MODEL	PRODUCT GROUP
JANUARY 1985	DL-578 DO,HO,W NEW	BATH LIGHTING

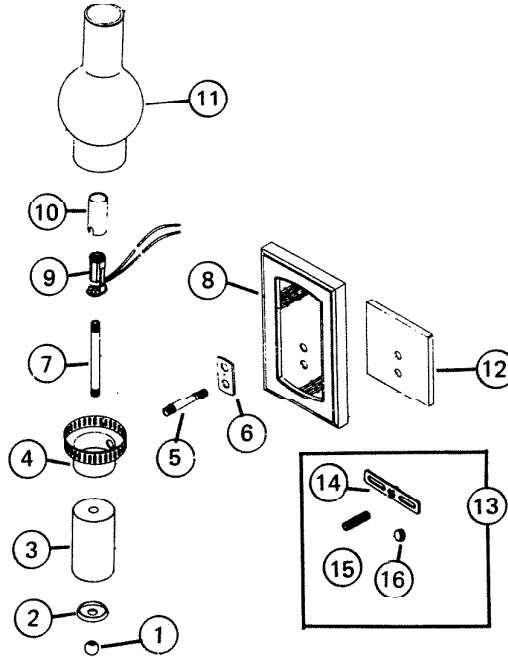

REF.	ORIGINAL PART NO.	* PART DESCRIPTION	MODEL USED ON	CURRENT REPLACEMENT PART NO.	
1	56782	BALL FINIAL	BRASS	DL-578HO,W	56782-H48
	56782		ANT.BRASS	DL-578DO	56782-H27
2	57468	CHECK RING	BRASS	DL-578HO,W	57468-H48
	57468		ANT.BRASS	DL-578DO	57468-H27
3	57467	ARM SPINDLE	H.OAK	DL-578HO	57467-A08
	57467		WHITE	DL-578W	57467-A06
	57467		D.OAK	DL-578DO	57467-A12
4	57464	GLASS HOLDER	BRASS	DL-578HO,W	57464-H48
	57464		ANT.BRASS	DL-578DO	57464-H27
5	57465	WIRING STEM	BRASS	DL-578HO,W	57465-H48
	57465		ANT.BRASS	DL-578DO	57465-H27
6	57448	BEZEL	BRASS	DL-578HO,W	57448-H48
	57448		ANT.BRASS	DL-578DO	57448-H27
7	57466	NIPPLE - 1/8"IPS X 4 1/4"	DL-578 DO,HO,W	57466-015	
		(PLEASE SEE OTHER SIDE)			

NuTone

PRINTED IN U.S.A.

NOTE: Always order by current part number.

REF.	ORIGINAL PART NO.	* PART DESCRIPTION	MODEL USED ON	CURRENT REPLACEMENT PART NO.	
8	57475	BACK PLATE W/INLAY	H.OAK	DL-578HO	57475-A08
	57475		WHITE	DL-578W	57475-A06
	57475		D.OAK	DL-578DO	57475-A12
9	L6593	CANDELABRA HOLDER	DL-578 DO,HO,W	L6593-000	
10	57416	CANDLESTICK	DL-578 DO,HO,W	57416-000	
11	57473	GLASS SHADE	DL-578HO,W	57473-000	
	57474		DL-578DO	57474-000	
12	57419	FLASHBACK	DL-578 DO,HO,W	57419-000	
13	57423	HARDWARE ASSEMBLY	DL-578HO,W	57423-000	
	57422		DL-578DO	57422-000	
14	L2406	BAR STRAP - 3 7/8"	DL-578 DO,HO,W	L2406-000	
15	57425	NIPPLE - 1/8"IPS X 1 1/2"	DL-578 DO,HO,W	57425-015	
16	57426	BRACKET CAP	BRASS	DL-578HO,W	57426-048
	57426		ANT.BRASS	DL-578DO	57426-027