

# PARTS LIST

EFFECTIVE DATE	MODEL	PRODUCT GROUP
JANUARY 1985	DL-558 NEW	BATH CABINET

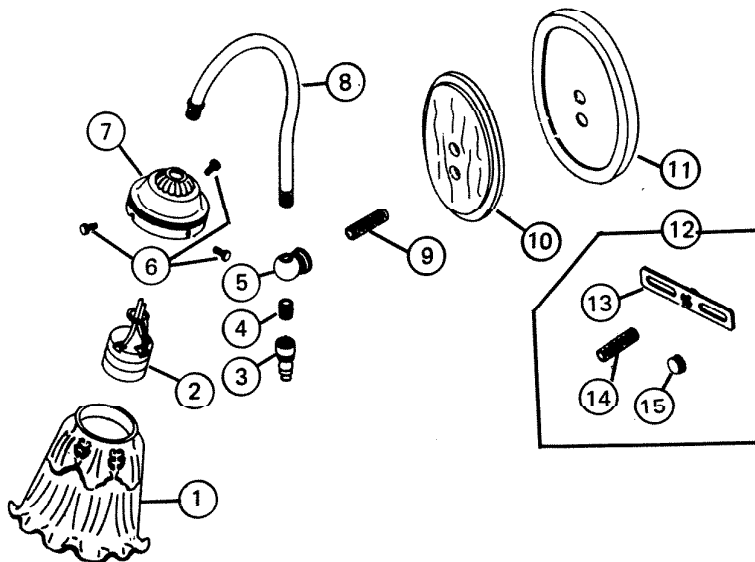

REF.	ORIGINAL PART NO.	* PART DESCRIPTION	MODEL USED ON	CURRENT REPLACEMENT PART NO.
1	57452	SHADE	DL-558	57452-000
2	57435	LAMPSOCKET - 18" LEADS	DL-558	57435-000
3	57432	FINIAL	DL-558	57432-H48
4	L2317	NIPPLE - 1/8" IPS X 1/2"	DL-558	L2317-015
5	57431	ARM BACK	DL-558	57431-H48
6	0827A	THUMB SCREW SET (3)	DL-558	0827A-000
7	57451	GLASS HOLDER	DL-558	57451-H48
8	57430	ARM PIPE	DL-558	57430-H48
9	L6580	NIPPLE - 1/8" IPS X 1"	DL-558	L6580-015
10	57440	WOOD INLAY	DL-558	57440-A08
11	57439	OVAL BACKPLATE	DL-558	57439-H48
12	57423	HARDWARE ASSEMBLY	DL-558	57423-000
13	L2406	BAR STRAP - 4"	DL-558	L2406-000
		(PLEASE SEE OTHER SIDE)		

**NuTone**

PRINTED IN U.S.A.

NOTE: Always order by current part number.

REF.	ORIGINAL PART NO.	* PART DESCRIPTION	MODEL USED ON	CURRENT REPLACEMENT PART NO.
14	57425	NIPPLE - 1/8" IPS X 1 1/2"	DL-558	57425-015
15	57426	BRACKET CAP	DL-558	57426-048