

PARTS LIST

EFFECTIVE DATE	MODEL	PRODUCT GROUP
APRIL 1979	DL-543 NEW	BATH CABINET

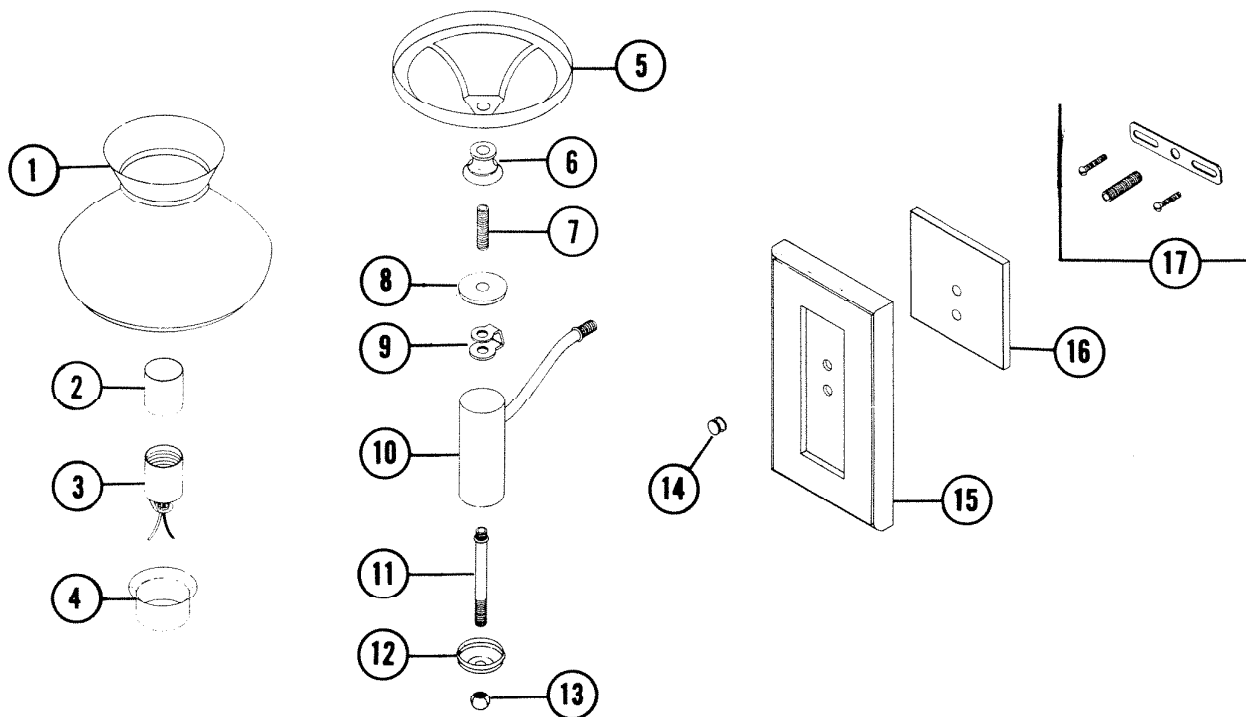

REF.	ORIGINAL PART NO.	* PART DESCRIPTION	MODEL USED ON	CURRENT REPLACEMENT PART NO.
1	2186A	GLASS SHADE	DL-543	H0859-000
2	2185A	CANDLESTICK	DL-543	H0858-000
3	2176A	LAMP SOCKET	DL-543	H0848-000
4	2195A	CUP	DL-543	H0882-HPB
5	2178A	SHADE RING	DL-543	H0849-HPB
6	5361A	NECK	DL-543	H0881-HPB
7	2197A	NIPPLE 1/8" IPS X 1 1/2 LG.	DL-543	H0865-000
8	2192A	CHECK RING	DL-543	H0879-HPB
9	2190A	HICKEY	DL-543	H0877-000
10	2189A	ARM & BODY ASSY	DL-543	H0871-000
11	2191A	PIPE 1/8" IPS	DL-543	H0878-000
12	2193A	ARM BODY CAP	DL-543	H0880-HPB
13	2196A	BALL FINIAL	DL-543	H0883-HPB
PLEASE SEE OTHER SIDE				

NuTone Division

NOTE: Always order by current part number.

PL - DL-543

REF.	ORIGINAL PART NO.	* PART DESCRIPTION	MODEL USED ON	CURRENT REPLACEMENT PART NO.
14	2199A	ENVELOPE ASSY 1 - CAP NUT	DL 543	H0885-000
15	2198A	BACKPLATE	DL-543	H0884-000
16	2184A	FLASH BACK	DL-543	H0857-000
17	2187A	ENVELOPE ASSY (MTG HDWE)	DL-543	H1054-000