

# PARTS LIST

EFFECTIVE DATE	MODEL	PRODUCT GROUP
MAY 1979	DL-518G, DL-518S REVISED	BATH CABINET

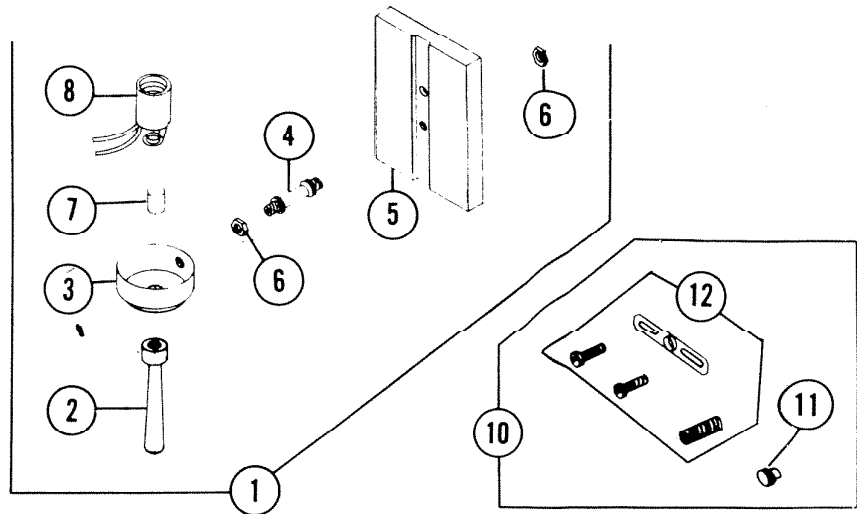
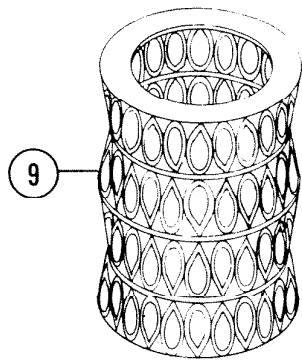

REF.	ORIGINAL PART NO.	* PART DESCRIPTION	MODEL USED ON	CURRENT REPLACEMENT PART NO.
1	69409	LIGHT FIXTURE ONLY	DL-518G	1279H-000
	69384		DL-518S	1280H-000
2	94341	FINIAL	DL-518G	H0922-H15
	93757		DL-518S	H0922-H07
3	H0914	SOCKET CUP	DL-518G	H0914-H14
	H0914		DL-518S	H0914-H07
4	94340	ARM	DL-518G	H0920-H14
	93755		DL-518S	H0920-H07
5	1312H	BACKPLATE ASSY	DL-518G	1312H-000
	69390		DL-518S	1313H-000
6	H0847	NUT HEX 1/8 I.P.S.	DL-518G	H0847-000
			DL-518S	
7	H0913	SPACER	DL-518G	H0913-000
			DL-518S	
8	5345A	LIGHT SOCKET	DL-518G	H0848-000
			DL-518S	
		(PLEASE SEE OTHER SIDE)		

**NuTone Division**

NOTE: Always order by current part number.  
PL - DL-518G 518S

REF.	ORIGINAL PART NO.	* PART DESCRIPTION	MODEL USED ON	CURRENT REPLACEMENT PART NO.
9	5346A	GLASS DRAPE	DL-518G DL-518S	H0924-000
10	5562A	HARDWARE SET	DL-518G	1314H-000
	5347A		DL-518S	1315H-000
11	H0925	ENVELOPE ASSY (SCREW)	DL-518G	H0925-000
	H0929		DL-518S	H0929-000
12	H1054	MOUNTING HARDWARE	DL-518G DL-518S	H1055-000