

PARTS LIST

EFFECTIVE DATE	MODEL	PRODUCT GROUP
JUNE 1979	DL-512, DL-512N REVISED	BATH CABINET

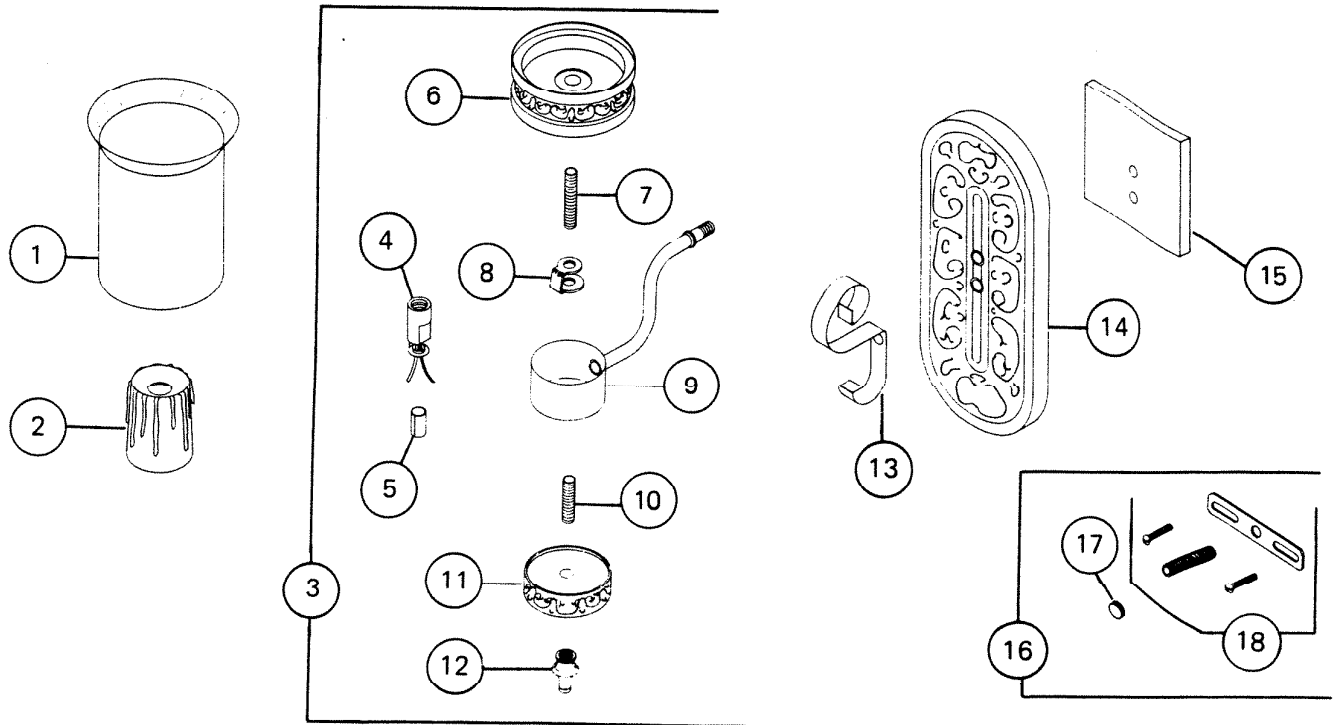

REF.	ORIGINAL PART NO.	* PART DESCRIPTION	MODEL USED ON	CURRENT REPLACEMENT PART NO.
1	H0972	GLASS CYLINDER	DL-512 DL-512N	H0972-000
2	H0958	CANDLESTICK	DL-512 DL-512N	H0958-000
3	1277H	LIGHT FIXTURE	DL-512 DL-512N	1277H-000
4	H0900	LIGHT SOCKET	DL-512 DL-512N	H0900-000
5	H0913	SPACER	DL-512 DL-512N	H0913-000
6	H0967	BOBECHE	DL-512 DL-512N	H0967-000
7	H0968	NIPPLE 1/8 I.P.S. X 2 1/4 LG.	DL-512 DL-512N	H0968-000
8	H0877	HICKEY	DL-512 DL-512N	H0877-000
9	H0964	ARM & ARM BODY ASSY	DL-512 DL-512N	H0964-H13
		(PLEASE SEE OTHER SIDE)		

Ni-tone

NOTE: Always order by
current part number
PL - DL-512, 512N

REF.	ORIGINAL PART NO.	* PART DESCRIPTION	MODEL USED ON	CURRENT REPLACEMENT PART NO.
10	H0865	NIPPLE 1/8 I.P.S. X 1 1/2" LG.	DL-512 DL-512N	H0865-000
11	H0969	CUP BASE	DL-512 DL-512N	H0969-000
12	H0854	FINIAL	DL-512 DL-512N	H0854-000
13	H0970	SCROLL	DL-512 DL-512N	H0970-H13
14	H0971	BACK PLATE	DL-512 DL-512N	H0971-000
15	H0857	FLASHBACK	DL-512 DL-512N	H0857-000
16	5283A	HARDWARE SET	DL-512 DL-512N	1272H-000
17	H0973	BRACKET CAP	DL-512 DL-512N	H0973-000
18	H1054	MTG HARDWARE	DL-512 DL-512N	H1054-000