

PARTS LIST

EFFECTIVE DATE	MODEL	PRODUCT GROUP
JANUARY 1985	DL-584D0, H0 NEW	BATH LIGHTING

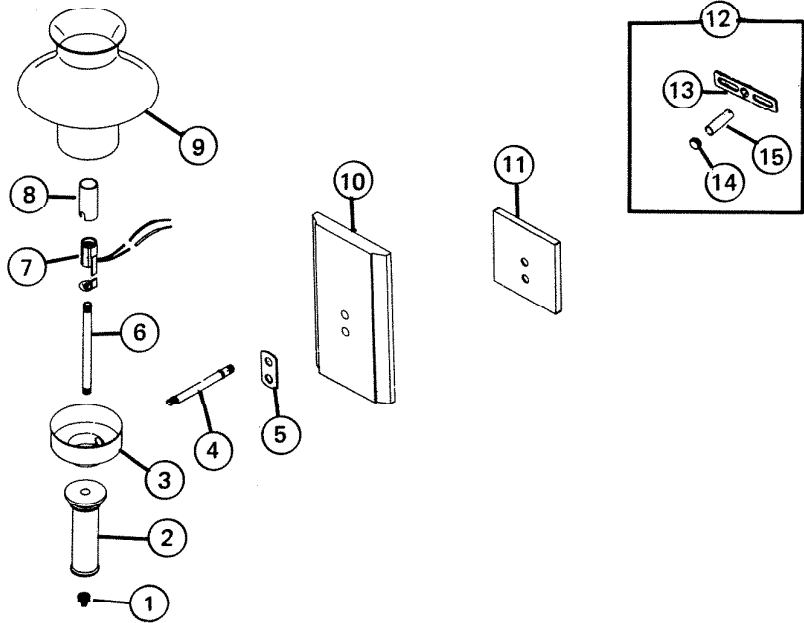

REF.	ORIGINAL PART NO.	* PART DESCRIPTION	MODEL USED ON	CURRENT REPLACEMENT PART NO.	
1	57447	FINIAL	AB	DL-584D0	57447-H27
	57447		PB	DL-584H0	57447-H48
2	57446	ARM SPINDLE	DL-584D0	57446-A12	
	57446		DL-584H0	57446-A08	
3	57441	GLASS HOLDER	AB	DL-584D0	57441-H27
	57441		PB	DL-584H0	57441-H48
4	57442	WIRING STEM	AB	DL-584D0	57442-H27
	57442		PB	DL-584H0	57442-H48
5	57448	BEZEL	AB	DL-584D0	57448-H27
	57448		PB	DL-584H0	57448-H48
6	57443	NIPPLE - 1/8" IPS	DL-584D0 DL-584H0	57443-015	
7	57444	CANDELABRA HOLDER	DL-584D0 DL-584H0	57444-000	
8	57416	CANDLESTICK	DL-584D0 DL-584H0	57416-000	
9	57450	GLASS SHADE	DL-584D0 DL-584H0	57450-000	
(PLEASE SEE OTHER SIDE)					

NuTone

NOTE: Always order by current part number.

RF#	ORIGINAL PART NO.	PART DESCRIPTION	MODEL USED ON	CURRENT REPLACEMENT PART NO.
10	57449	BACKPLATE	DL-584D0	57449-A12
	57449		DL-584H0	57449-A08
11	57419	FLASHBACK	DL-584D0 DL-584H0	57419-000
12	57422	HARDWARE ASSEMBLY	DL-584D0	57422-000
	57423		DL-584H0	57423-000
13	L2406	BAR STRAP - 3 7/8"	DL-584D0 DL-584H0	L2406-000
14	57426	BRACKET CAP	AB DL-584D0	57426-027
	57426		PB DL-584H0	57426-048
15	57425	NIPPLE - 1/8"IPS X 1 1/2"	DL-584D0 DL-584H0	57425-015