

PARTS LIST

EFFECTIVE DATE	MODEL	PRODUCT GROUP
JAN. 1990	9110 9110N REVISED	HEATER

NOT A PARTS DEPT. STOCK ITEM

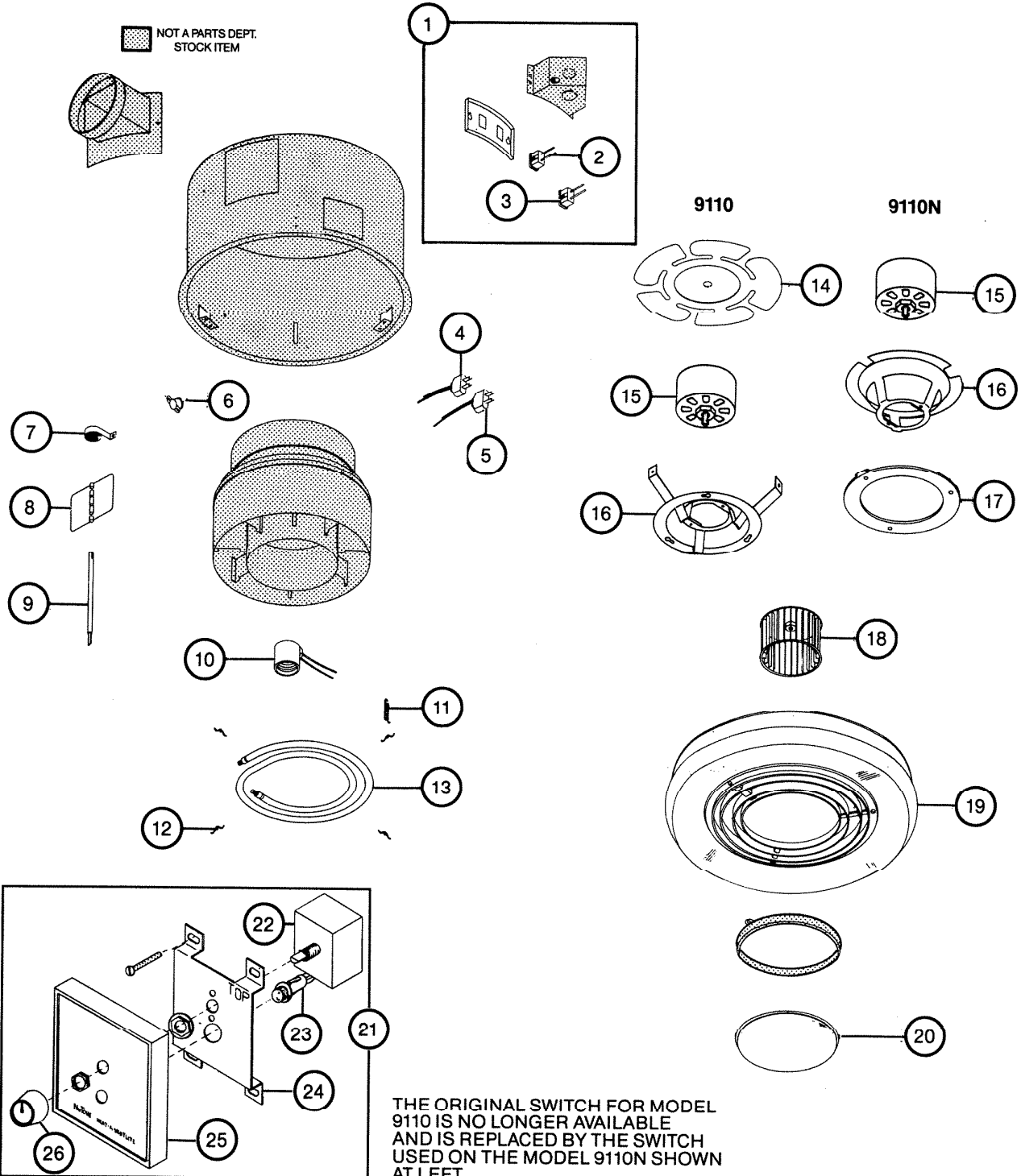

NuTone

REF.	ORIGINAL PART NO.	*PART DESCRIPTION		CURRENT REPLACEMENT PART NO.	
1	18082	OUTLET BOX COVER ASSEMBLY		18082-000	
2	10034	PLUG RECEPTACLE--BLACK		10034-000	
3	18105	PLUG RECEPTACLE--WHITE		56721-000	
4	18067	HEAT PLUG ASSEMBLY--WHITE		18228-000	
5	20659	BROWN PLUG ASSEMBLY		20658-000	
6	16480	THERMAL PROTECTOR	9110	19871-000	
	18287		9110N	19865-000	
7	16444	BUTTERFLY ACTUATOR		16444-000	
8	16449	BUTTERFLY-DAMPER		VOID NOT AVAILABLE	
9	16789	BUTTERFLY SHAFT			
10	16438	LAMP SOCKET ASSEMBLY			
11	16437	ELEMENT SPRING			
12	11318	ELEMENT HOOK			
13	16476	HEATING ELEMENT			16476-000
14	16456	FAN BLADE ASSEMBLY	9110	69288-000	
15	16454	MOTOR	Double Shaft	9110	18214-000
	20688		1962-1965 Studs on the Back	9110N	20688-SER
	26716		1965-1967 Studs on Shaft Side		26716-SER
16	16451	MOTOR BRACKET-VENTURI	9110	VOID NOT AVAILABLE	
	16292		9110N		
17	19617	GASKET	9110N		
18	16296	BLOWER WHEEL	9110	16296-000	
	13655		9110N	13655-000	
19	18143	GRILLE ASSEMBLY		VOID NOT AVAILABLE	
20	18148	LENS ONLY--wo/Bezel		18148-000	

NOTE: Always order by current part number.

REF.	ORIGINAL PART NO.	*PART DESCRIPTION	CURRENT REPLACEMENT PART NO.
21	21441	SWITCH ASSEMBLY COMPLETE	21441-000
22	27612	ROTARY SWITCH	27612-000
23	21447	PILOT LITE	21447-000
24	21445	SWITCH AND PILOT LITE MOUNTING BRACKET	21445-000
25	21442	SWITCH PLATE ASSEMBLY	21442-000
26	9052A	KNOB	9052A-000

↑

NOTE: Always order by current part number.

