

# PARTS LIST

EFFECTIVE DATE	MODEL	PRODUCT GROUP
JAN. 1990	0090 9090N REVISED	HEATER

 NOT A PARTS DEPT. STOCK ITEM

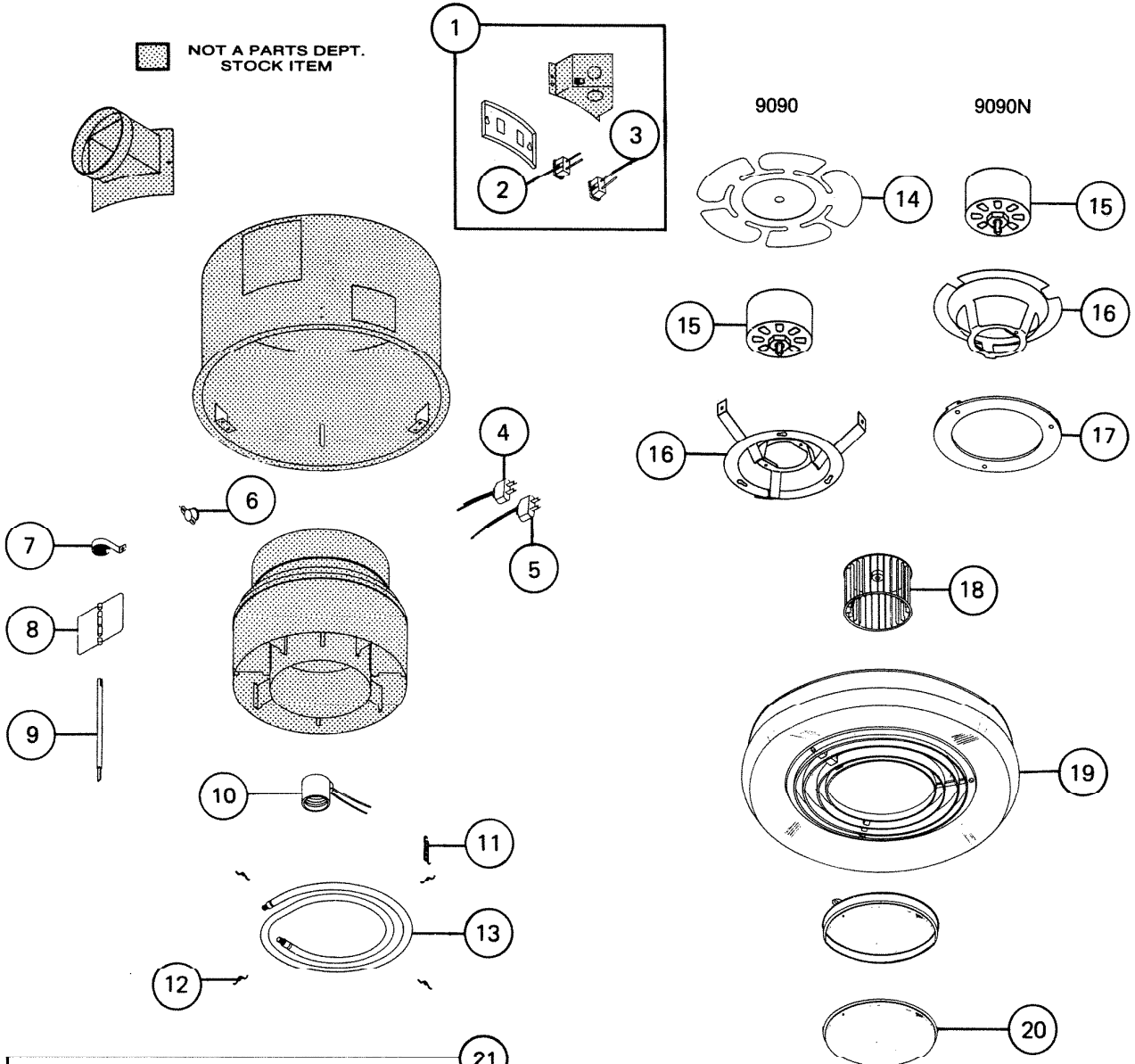

The original switch for model 9090 is no longer available and is replaced by the switch used on the model 9090N shown at left.

REF.	ORIGINAL PART NO.	*PART DESCRIPTION		CURRENT REPLACEMENT PART NO.	
1	18082	OUTLET BOX COVER ASSEMBLY		18082-000	
2	10034	PLUG RECEPTACLE-BLACK		10034-000	
3	18105	PLUG RECEPTACLE-WHITE		56721-000	
4	18067	HEAT PLUG ASSEMBLY-WHITE		18228-000	
5	20658	BROWN PLUG ASSEMBLY		20658-000	
6	16480	THERMAL PROTECTOR	9090	19871-000	
	18287		9090N	19865-000	
7	16444	BUTTERFLY ACTUATOR		16444-000	
8	16449	BUTTERFLY-DAMPER		VOID NOT AVAILABLE	
9	16789	BUTTERFLY SHAFT		VOID NOT AVAILABLE	
10	16438	LAMP SOCKET ASSEMBLY	9090	VOID NOT AVAILABLE	
			9090N	52328-000	
11	16437	ELEMENT SPRING		VOID NOT AVAILABLE	
12	11318	ELEMENT HOOK		VOID NOT AVAILABLE	
13	10593	HEATING ELEMENT		10593-000	
14	16456	FAN BLADE ASSEMBLY	9090	69288-000	
15	16454	MOTOR	Double Shaft	9090	18214-000
	20688		1962-1965 Studs on the Back	9090N	20688-SER
	26716		1965-1967 Studs on Shaft Side		26716-SER
16	16451	MOTOR BRACKET-VENTURI		9090	VOID NOT AVAILABLE
	16292			9090N	VOID NOT AVAILABLE
17	19617	GASKET		9090N	VOID NOT AVAILABLE
18	16296	BLOWER WHEEL	9090	16296-000	
	13655		9090N	13655-000	
19	18143	GRILLE ASSEMBLY		VOID NOT AVAILABLE	
20	18148	LENS ONLY--wo/Bezel		18148-000	

↑

**NOTE: Always order by current part number.**

REF.	ORIGINAL PART NO.	*PART DESCRIPTION	CURRENT REPLACEMENT PART NO.
21	21441	SWITCH ASSEMBLY COMPLETE	21441-000
22	27612	ROTARY SWITCH	27612-000
23	21447	PILOT LITE	21447-000
24	21445	SWITCH AND PILOT LITE MOUNTING BRACKET	21445-000
25	21442	SWITCH PLATE ASSEMBLY	21442-000
26	9052A	KNOB	9052A-000

↑

**NOTE: Always order by current part number.**

