

PARTS LIST

EFFECTIVE DATE	MODEL NUMBER	PRODUCT GROUP
JANUARY 1995	8673DG REVISED 8673NLDG/LG NEW	FAN

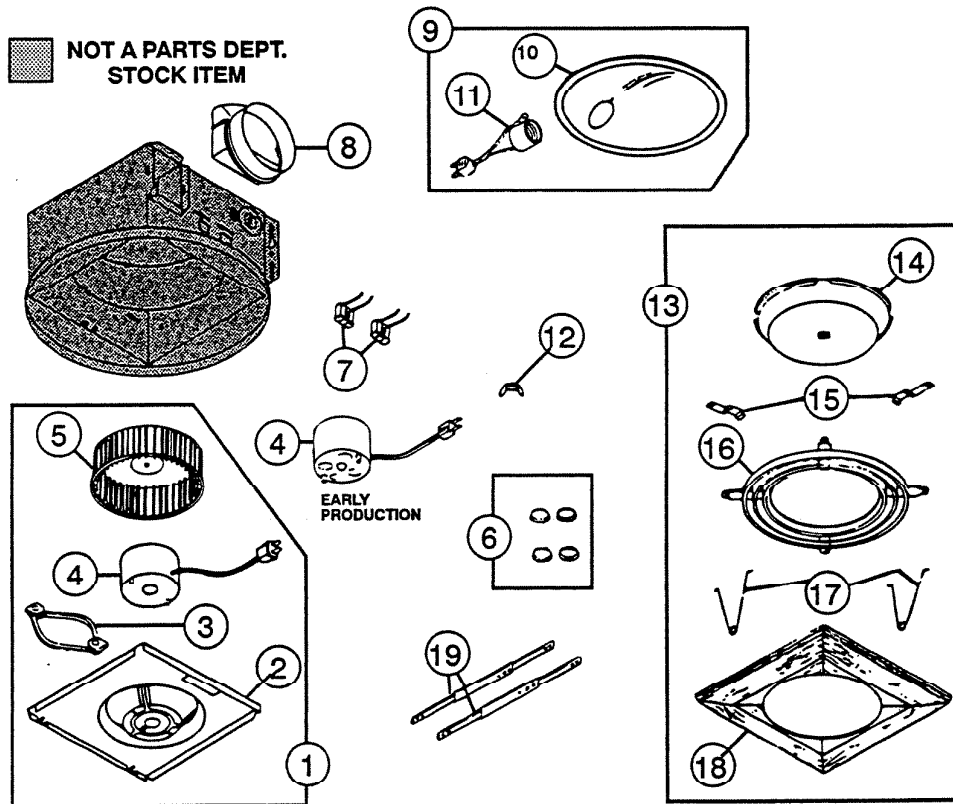

REF.	ORIGINAL PART NO.	*PART DESCRIPTION	MODEL USED ON	CURRENT REPLACEMENT PART NO.
1	0411A	POWER UNIT ASSEMBLY	8673DG	0411A-000
2	57804	MOTOR MOUNTING PLATE	8673DG	0455A-000
3	0441A	MOTOR ISOLATION MOUNT (with ground clip)	8673DG	0441A-000
4	53581	MOTOR	8673DG	0407A-000
5	51919	BLOWER WHEEL w/push nut	8673DG	5900A-000
6	0406A	BUMPER SET (Early production)	8673DG	0406A-000
(PLEASE SEE OTHER SIDE)				

NuTone

NuTone
Attn: Parts Department
Madison & Red Bank Rds.
Cincinnati, OH 45227-1599
Phone: (513) 527-5426
Fax: (513) 527-5173

NOTE: Always order by
current part number

REF.	ORIGINAL PART NO.	*PART DESCRIPTION	MODEL USED ON	CURRENT REPLACEMENT PART NO.
7	10034	PLUG RECEPTACLE (1) — 2 Required	8673DG	10034-000
8	53697	DUCT ADAPTOR ASSEMBLY	8673DG	30652-000
9	57805	REFLECTOR ASSEMBLY	8673NLDG/LG	36893-000
			8673DG	57805-000
10	57806	REFLECTOR ONLY	8673NLDG/LG	36894-000
			8673DG	57806-000
11	53588	SOCKET ASSEMBLY	8673NLDG/LG	36895-000
			8673DG	53588-000
12	16133	WING NUT 1/4 — 20	8673DG	16133-000
13	57841	GRILLE ASSEMBLY (SQUARE)	8673NLLG	44451-000
			8673DG	57841-000
14	53585	LENS (ROUND)	8673DG	53585-000
15	32837	RETAINER — LENS (1), 2 Required	8673DG	33426-015
16	32834	GRILLE ONLY	8673DG	58796-000
17	57000	SPRING SET (2)	8673DG	0444A-000
18	58798	BEZEL (SQUARE)	8673NDLG/LG	58798-279
			8673DG	58798-280
19	13306	HANGER ROD SET (2)	8673DG	13306-000



NOTE: Always order by current part number