

# PARTS LIST

EFFECTIVE DATE	MODEL NUMBER	PRODUCT GROUP
JANUARY 1995	8210 REVISED	FAN

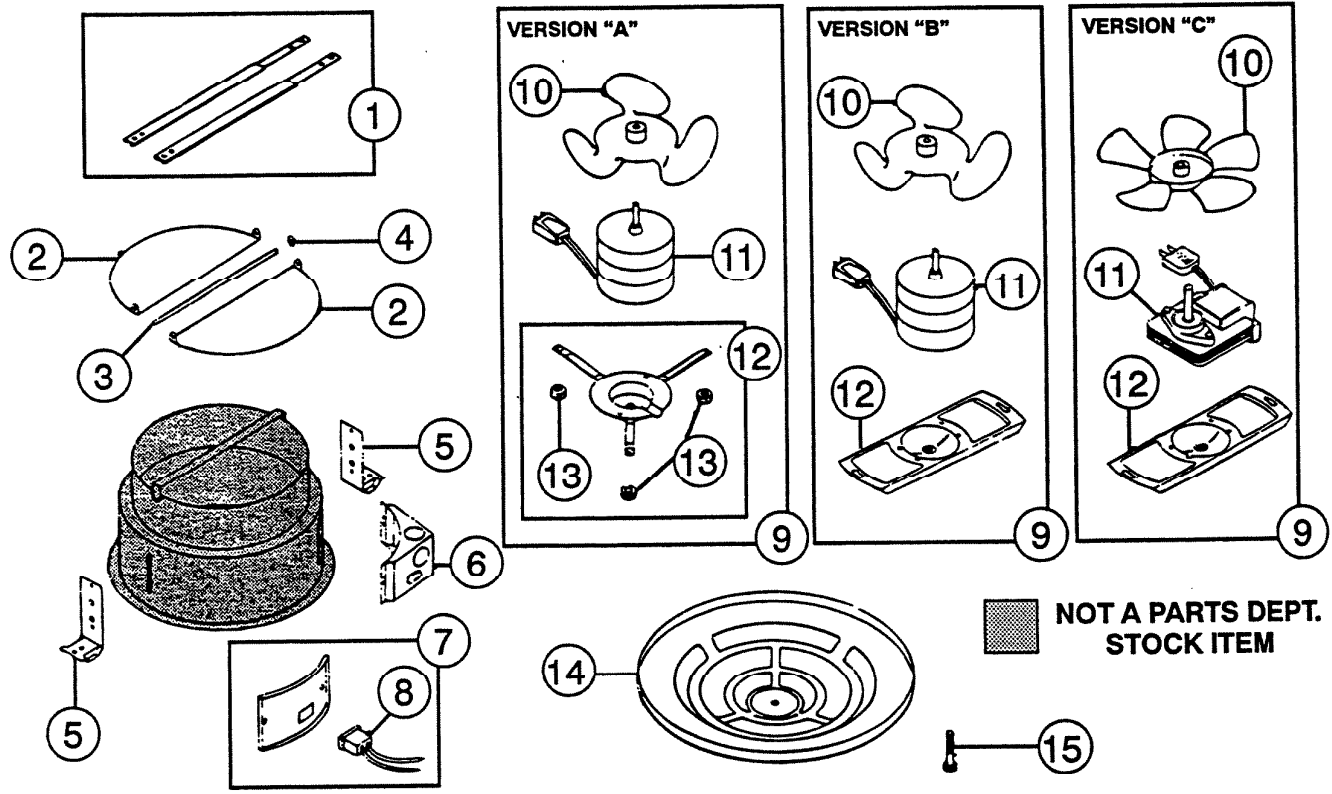

REF.	ORIGINAL PART NO.	*PART DESCRIPTION	CURRENT REPLACEMENT PART NO.
1	13306	HANGER ROD SET	13306-000
2	16754	DAMPER HALF — 2 REQUIRED	16754-000
3	16755	HINGE ROD	16755-000
4	16756	TINNERMAN NUT	16756-000
5	53194	CEILING MOUNTING BRACKET ASSEMBLY — SET OF 4	53194-000
(PLEASE SEE OTHER SIDE)			

# NuTone

NuTone  
 Attn: Parts Department  
 Madison & Red Bank Rds.  
 Cincinnati, OH 45227-1599  
 Phone: (513) 527-5426  
 Fax: (513) 527-5173

↑

**NOTE: Always order by current part number**

REF.	ORIGINAL PART NO.	*PART DESCRIPTION			CURRENT REPLACEMENT PART NO.	
6	10473	OUTLET BOX			10473-000	
7	10247	OUTLET BOX COVER ASSEMBLY			10247-000	
8	10034	PLUG RECEPTACLE			10034-000	
9	69032	"B" UNIT — Version "C" Replaces Version "B"			Version "A"	VOID-NOT AVAILABLE
	16665				Version "B"	16665-000
					Version "C"	
10	16641	FAN BLADE — For	1/4" Dia. Shaft	Aluminum	Version "A"	16631-000
	27860		7/32" Dia. Shaft Approx.	Plastic See Note*	Version "B"	68293-000
	68293				Version "C"	
	68293					
11	16633	MOTOR	1/4" Dia. Shaft		Version "A"	16653-SER
	16666		7/32" Dia. Shaft Approx. See Note*		Version "B"	34417-000
	34417				Version "C"	
12	10744	MOTOR BRACKET ASSEMBLY			Version "A"	VOID-NOT AVAILABLE
	17674				Version "B" Version "C"	17674-000
13	10058	GROMMET SET (3)			Version "A"	1241A-000
14	17719	GRILLE ASSEMBLY				17701-018
15	11246	GRILLE SCREW				12220-001
	17220					

\*NOTE: Early Production Version "B" had an Aluminum Fan Blade P/N 27860-000 and is replaced by the Plastic Blade P/N 68293-000

\*\*NOTE: When replacing motor P/N 16666-000 on model 8210 with motor P/N 34417-000, use the two holes on the side of the motor bracket, shown below.

↑

NOTE: Always order by current part number