

PARTS LIST

EFFECTIVE DATE	MODEL NUMBER	PRODUCT GROUP
JANUARY 1995	8148 REVISED	EXHAUST FAN

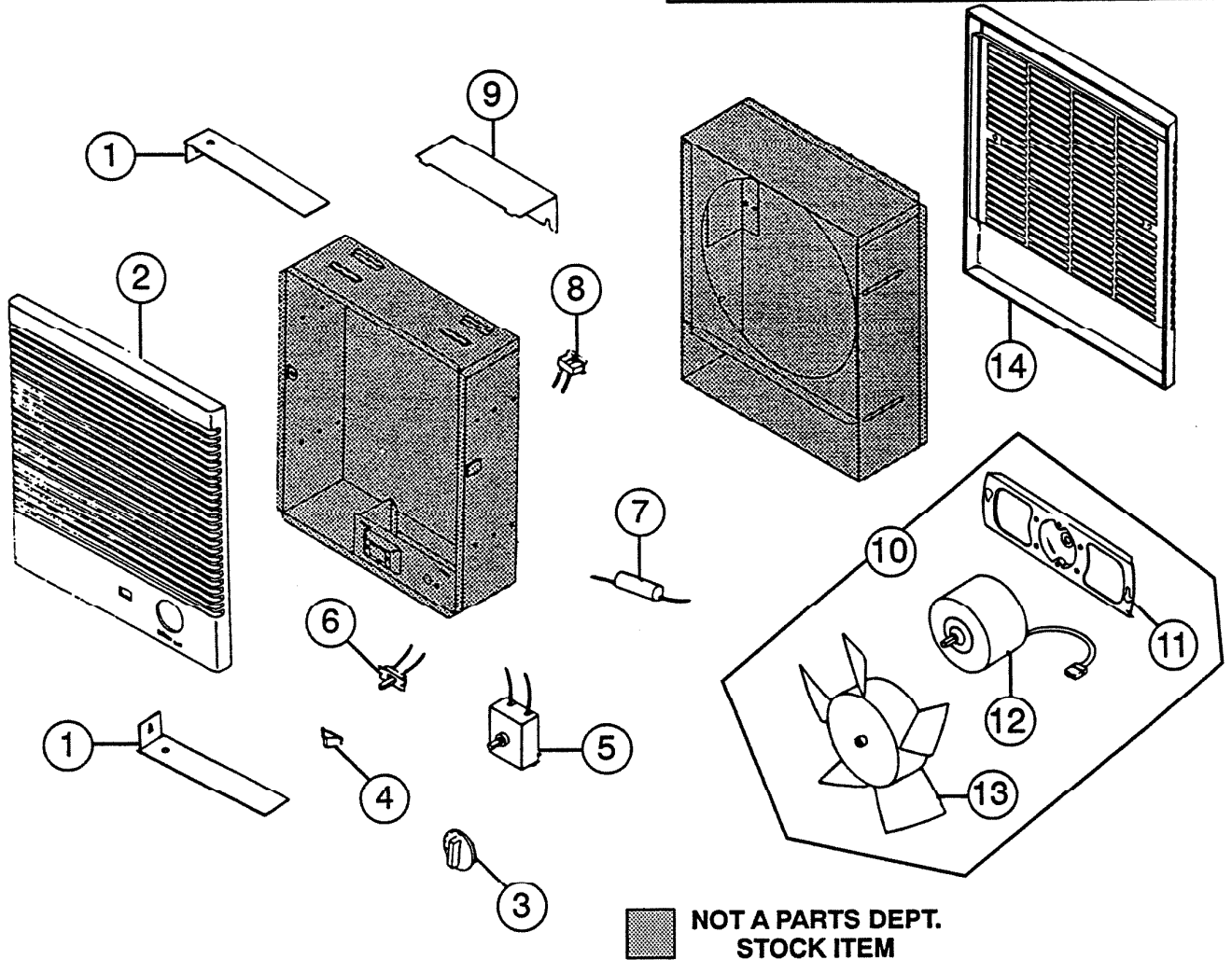

REF.	ORIGINAL PART NO.	*PART DESCRIPTION	MODEL USED ON	CURRENT REPLACEMENT PART NO.
1	19767	MOUNTING BRACKET SET	8148	69102-000
2	56772	GRILLE W/KNOCKOUTS	8148	VOID-NOT AVAILABLE
3	52391	KNOB	8148	52391-000
4	56774	SWITCH CAP	8148	VOID-NOT AVAILABLE
5	68423	SPEED CONTROL	8148	68423-000
(PLEASE SEE OTHER SIDE)				

NuTone

NuTone
 Attn: Parts Department
 Madison & Red Bank Rds.
 Cincinnati, OH 45227-1599
 Phone: (513) 527-5426
 Fax: (513) 527-5173

↑
NOTE: Always order by current part number

REF.	ORIGINAL PART NO.	*PART DESCRIPTION	MODEL USED ON	CURRENT REPLACEMENT PART NO.
6	56778	SLIDE SWITCH	8148	VOID-NOT AVAILABLE
7	56765	CAPACITOR — 2mf	8148	VOID-NOT AVAILABLE
8	1339A	PLUG HOUSING ASSEMBLY	8148	1339A-000
9	53433	WIRING BOX COVER	8148	VOID-NOT AVAILABLE
10	56766	POWER UNIT ASSEMBLY	8148	VOID-NOT AVAILABLE
11	56768	FAN BLADE	8148	VOID-NOT AVAILABLE
12	56767	MOTOR	8148	VOID-NOT AVAILABLE
13	11839	MOTOR BRACKET	8148	11839-000
14	52388	GRILLE — BLANK	8148	52388-000
	56773	HARDWARE BAG ASSEMBLY (NOT SHOWN — CONTAINS MTG. SCREW AND SWITCH KNOBS)	8148	VOID-NOT AVAILABLE

↑

NOTE: Always order by current part number