

PARTS LIST

EFFECTIVE DATE	MODEL NUMBER	PRODUCT GROUP
JANUARY 1995	8141 REVISED	ROOM-TO-ROOM FAN

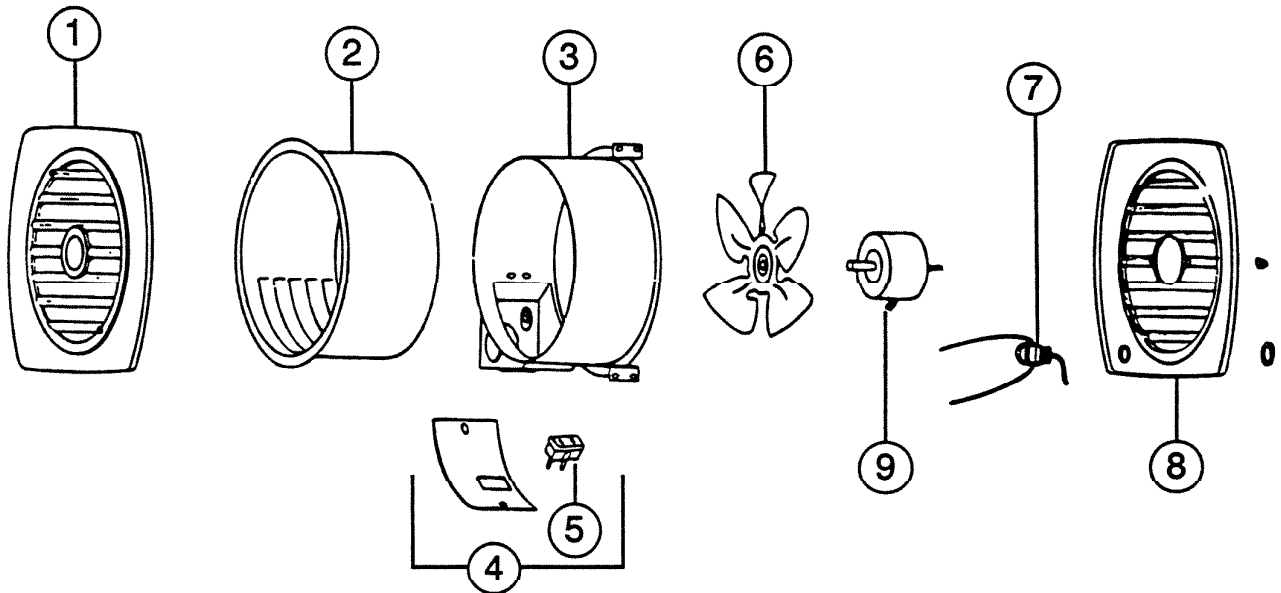

REF.	ORIGINAL PART NO.	*PART DESCRIPTION	MODEL USED ON	CURRENT REPLACEMENT PART NO.
1	21338	GRILLE ASSEMBLY	8141	21338-000
2	21333	INNER SLEEVE ASSEMBLY	8141	Void - not avail.
3	21330	OUTER SLEEVE ASSEMBLY	8141	Void - not avail.
4	21334	OUTLET BOX COVER ASSEMBLY	8141	21334-000
5	10034	RECEPTACLE	8141	10034-000
6	11805	FAN BLADE	8141	11805-000
7	11471	SWITCH	8141	11471-000
8	21336	OUTER GRILLE ASSEMBLY	8141	21336-000
9	26750	MOTOR (NO. ON DATA PLATE AK4125A)	8141	26750-SER
--	21340	ENVELOPE ASSEMBLY - 4 SCREWS AND 1 PULL STRING (NOT SHOWN)	8141	21340-000
--	21332	MOUNTING BRACKET (NOT SHOWN)	8141	Void - not avail.

NuTone

NuTone
 Attn: Parts Department
 Madison & Red Bank Rds.
 Cincinnati, OH 45227-1599
 Phone: (513) 527-5426
 Fax: (513) 527-5173

↑

NOTE: Always order by current part number