

# PARTS LIST

<b>MODEL</b>	462 ELECTRONICS
<b>EFFECTIVE DATE</b>	January 1, 1972

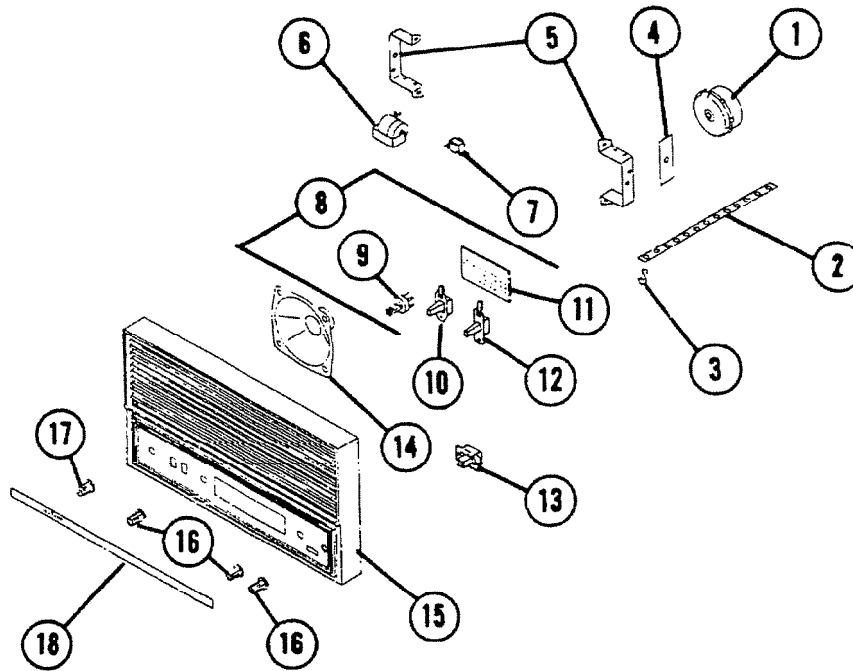

REF.	PART NO.	Part used on other models.	NOMENCLATURE
1	36069		Alarm Horn
2	31986		Strap
3	31987		Hook
4	39219		Insulator Horn
5	38364		Bracket
6	36059		Buzzer
7	30586		Transformer
8	41291		P.C. Board Assy. - Intercom
9	34033		Potentiometer
10	34564		Talk/Listen Switch
11	37504		P.C. Board
12	34563		Door Switch
13	34580		Home-Off-Exit Switch
14	36017		Speaker 45 ohm

PLEASE SEE OTHER SIDE

**NuTone Division**

Order Parts From: Parts Department c/o  
NuTone  
Madison & Red Bank Road  
Cincinnati, Ohio 45227



REF.	PART NO.	Part used on other models.	NOMENCLATURE
15	41286		Front Panel W/Inlay
16	39205		Knob Radio
17	39206		Knob Intercom
18	38357		Panel Inlay
--	41292		Envelope Assy. (Mtg. Bracket, Screws and Wire Nuts Etc.)
<u>ELECTRONIC PARTS</u>			

## PARTS LIST

### Model 462-B Radio Chassis

#### COILS

L 1	60227	Antenna FM
L 2	60230	Antenna AM
L 3	60228	RF Amp
L 4	60229	Oscillator FM
L 5	60231	Oscillator AM
L 6	60232	Emitter Choke
L 7	60233	Choke
L 8	60234	Choke
L10	30074	RF Choke

#### TRANSFORMERS

T 1	60237	1st IF FM
T 2	60237	2nd IF FM
T 3	60239	1st IF AM
T 4	60237	3rd IF FM
T 5	60240	2nd IF AM
T 6	60238	4th IF FM
T 7	60241	3rd IF AM
T 9	60243	Driver
T10	60242	Power
T11	60244	Output
T13	30585	Intercom Input
T14	30586	Alarm

#### COMBINATION COMPONENTS

M 1	60250-325	Capristor
M 2	60250-324	Capristor
M 3	60250-344	Capristor
M 4	60250-343	Capristor
M 5	60250-332	Capristor
M 6	60250-315	Capristor
M 7	60250-307	Capristor
M 8	60250-303	Capristor
M 9	60250-333	Capristor
M10	60246	AM/FM Switch
M13	60281	Thermistor
M14	60281	Thermistor

#### DIODES

D 1	60280	
D 2	60279	
D 3	60279	
D 4	60280	
D 5	60280	
D 6	60245	
D 7	60245	
D 8	36508	(1N295)
D 9	36549	(Motorola 1N4002)
D10	36549	(Motorola 1N4002)
D11	36549	(Motorola 1N4002)

#### TRANSISTORS

TR 1	60272	FM RF Amp
TR 2	60273	FM Converter
TR 3	60274	AFC
TR 4	60275	IF Amp
TR 5	60276	IF Amp
TR 6	60275	IF Amp
TR 7	60277	Audio Amp
TR 8	60277	Driver
TR 9	60278	Output
TR10	60278	Output

#### RESISTORS

R 1	60247	50K Volume Control/Switch
R 3		22K
R 4		100
R 5		1K
R 6		10K
R 7		100
R 8		100
R 9		33K
R10		220K
R11		47
R12		10K
R13		33K
R14		33K
R15		5.6K
R16		1.5K
R17		33K
R18		100K
R19		100
R20		1.5K
R21		22K
R22		220
R23		10K
R24		1K
R25		1K
R26		100
R27		1K
R29		15K
R30		10K
R33		470K
R34		6.8K
R35		470
R36		1.5K
R37		220K
R38		68K
R39		68K
R40		47
R41		150
R42		2.2K
R43		100
R44		1

## PARTS LIST

### Model 462-B Radio Chassis

#### RESISTORS (continued)

R45	2.2K
R46	100
R47	1
R48	6.8K
R49	100
R50	500K Level-set
R52	4.7K (Shorted)
R56	22K
R57	470
R60	15K
R61	1 Meg
R62	180K
R63	68K

#### CAPACITORS (50V unless otherwise noted)

C1 thru C8	
60249	AM/FM Tuning Gang
C 9	30 Pfd Discap
C10	4 Pfd Ceramic
C11	18 Pfd Ceramic
C12	.001 Mfd Discap
C13	4 Pfd Discap
C14	6 Pfd Discap
C15	300 Pfd Discap
C16	70 Pfd Discap
C17	10 Pfd Ceramic
C18	.022 Mfd 25V Discap
C19	7 Pfd Discap
C20	.022 Mfd 25 V Discap
C21	10 Mfd 16V Electrolytic
C22	300 Pfd Discap
C23	
C24	.01 Mfd Mylar
C25	.01 Mfd Mylar
C26	1 Pfd Discap
C27	33 Mfd 6V Electrolytic
C28	7 Pfd Discap
C29	33 Mfd 6V Electrolytic
C30	2 Pfd Discap
C31	1 Pfd Discap
C32	.022 Mfd 25V Discap
C33	.022 Mfd 25V Discap
C34	1 Pfd Discap
C35	1 Pfd Discap
C36	3 Pfd Discap
C37	.022 Mfd 25V Discap

C38	47 Mfd 6V Electrolytic
C39	.001 Mfd Discap
C40	.01 Mfd Mylar
C41	10 Pfd Ceramic
C42	33 Mfd 16V Electrolytic
C43	15 Pfd Ceramic
C44	220 Mfd 25V Electrolytic
C45	.1 Mfd 15 Volt Electrolytic
C46	1 Mfd 50V Electrolytic
C47	10 Mfd 16V Electrolytic
C48	10 Mfd 16V Electrolytic
C49	10 Mfd 16V Electrolytic
C50	1000 Mfd 16V Electrolytic
C51	.01 Mfd Mylar
C52	.01 Mfd Mylar
C53	1000 Mfd 16V Electrolytic
C54	.01 Mfd Mylar
C55	160 Pfd Barium
C56	1000 Mfd 16V Electrolytic
C58	.0047 Mfd Mylar
C59	.0047 Mfd Mylar
C60	.01 Mfd Mylar
C61	.047 Mfd Mylar
C64	160 Pfd Barium
C65	12 Pfd

#### MISCELLANEOUS

60220	Dial Pointer
60221	Dial
60224	Dial Shaft
60225	Dial Pully Wheel
60226	Dial Cord Spring
60252	Dial Pully Screw
60255	Dial Cord
60223	Heat Sink
32645	Interlock Cord Plug
41286	Front Panel
36017	Master Speaker (45 Ohms)
39205	Radio Knob
39206	Intercom Knob
34600	Home-Off-Exit Switch (SW-21)
31487	Terminal Strip (5 Screw)
41291	Intercom P/C Board
41284	Alarm P/C Board
31986	Nylon Strap
31987	Hook
36069	Alarm Horn
36040	Buzzer

## VOLTAGE MEASUREMENTS ALARM CIRCUIT

NOTE: BEFORE ANY VOLTAGE READINGS ARE TAKEN — SUBSTITUTE A 68 OHM 4 WATT RESISTOR FOR THE ALARM HORN.

TEST CONDITIONS: Selector switch on Master in "AUX" position — Master and System Volume Controls set at minimum — Nominal 120V AC input — readings taken are with respect to chassis using a VTVM. (See Note #1)

		TR-1		SCR-1		TR-2		SCR-2
SW-21 in OFF position, intruder loop open or closed	E	0.0	C	0.0	E	0.0	C	0.0
	B	0.0	G	0.0	B	0.0	G	0.0
	C	0.0	A	0.0	C	0.0	A	0.0
SW-21 in HOME or EXIT position intruder loop closed	E	-16.0	C	-16.0	E	-16.0	C	-16.0
	B	-15.7	G	-16.0	B	-16.0	G	-16.0
	C	0.0	A	0.0	C	0.0	A	0.0
SW-21 in HOME or EXIT position intruder loop open for approx. 3 mins.	E	-10.8	C	-10.8	E	-12.5	C	-13.4
	B	-11.4	G	-10.0	B	-11.8	G	-12.5
	C	-9.5	A	-10.0	C	-12.5	A	-12.5

NOTE #1 A METER CONNECTION TO TR-1 BASE MAY TRIGGER SCR-1.

### PARTS LIST — ALARM

#### TRANSISTORS

REF. NO.	NUTONE PART NO.	DESCRIPTION
TR-1	36580 (Motorola M-6)	
TR-2	36580 (Motorola M-6)	
SCR-1	36507 (Motorola 2N5060)	Signal SCR
SCR-2	36506 (GE C106Y1)	Power SCR

#### RESISTORS

R-1	33101-222	2.2K Ohms
R-2	33101-684	680K Ohms
R-3	33101-103	10K Ohms
R-4	33101-224	220K Ohms
R-5	33101-472	4.7K Ohms
R-6	33101-102	1K Ohms
R-7	33101-684	680K Ohms
R-8	33101-680	68 Ohms
R-9	33101-331	330 Ohms
R-10	33101-101	100 Ohms
R-11	33101-823	82K Ohms
R-12	33101-222	2.2K Ohms
*R-13	33101-102	1K Ohms
R-14	33101-222	2.2K Ohms
R-15	33101-102	1K Ohms
R-16	33101-100	10 Ohms
*R-17	33101-100	10 Ohms
**R-18	33025-271	270 Ohms
		2 Watt
*R-19	33101-682	6.8K Ohms
R-20	33101-153	15K Ohms

\* Located on Chassis Terminal Strip  
\*\* Located on Door Buzzer.

#### CAPACITORS

REF. NO.	NUTONE PART NO.	DESCRIPTION
C-1	35100-127	.1 mfd @ 50V
C-2	35100-139	.01 mfd @ 50V
C-3	35068-106	2 mfd @ 50V
C-4	35100-139	.01 mfd @ 50V
C-6	35068-111	390 mfd @ 3V
C-7	35066-102	.15 mfd @ 50V
*C-8	35068-102	300 mfd @ 15V
*C-9	35100-134	470 pf @ 50V
C-10	35066-103	.22 @ 150V
**C-11	35066-103	.22 @ 150V

\* Located on Chassis Terminal Strip  
\*\* Located on Door Buzzer.

### INTERCOM P/C BOARD

#### RESISTORS

REF. NO.	NUTONE PART NO.	DESCRIPTION
R-64	34033	Potentiometer 50 Ohms
R-65	33101-270	27 Ohms

#### CAPACITORS

C-66	35085-103	1000 mfd @ 3V
------	-----------	---------------

#### SWITCHES

M-22	34563	DPDT Door Switch
M-23	34564	4PDT Talk/Listen Switch