

EFFECTIVE DATE

May 1, 1970

NuTone PARTS LIST

MODEL

2575

Speaker Clock Timer

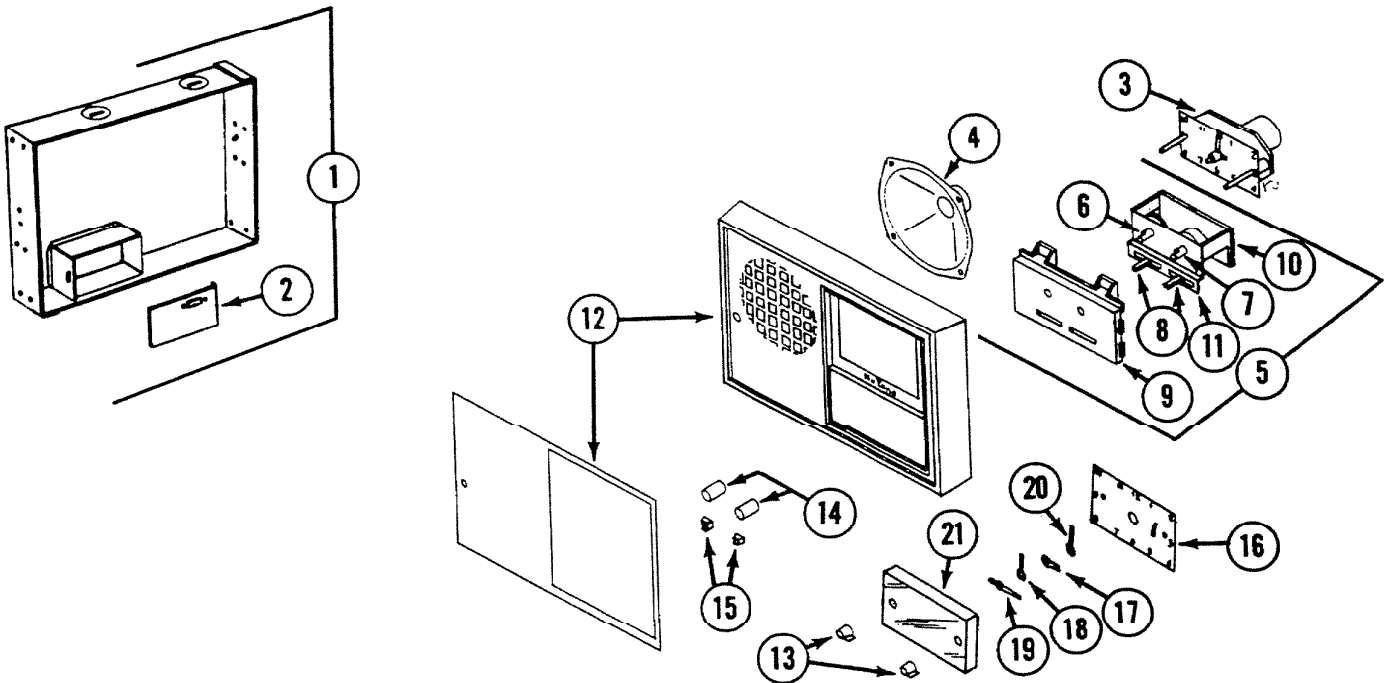

REF.	PART NO.	*Part used on other model/s	PART DESCRIPTION
1	40859		"A" Box Assembly
2	40071		Cover Assembly
3	40913		Clock Timer Assembly
4	36017		Speaker - 45 Ohm.
5	40915		Control Insert Assembly
6	34024		Potentiometer
7	34531		Rotary Switch, 3-Position
8	34529		Lever Switch (2 required)
9	38060		Control Insert
10	40916		Terminal Board Bracket Assembly
11	32177		Backing Bracket
12	38067		Front Panel
13	39015		Knob - Clock (2 required)

Order Parts From: PARTS DEPT. C/O

NuTone **SCOVILL**

DIVISION

PRINTED IN U.S.A.

REF.	PART NO.	*Part used on other model/s	PART DESCRIPTION
14	39054		Knob Volume or Selector (2 required)
15	7707		Knob Lever (2 required)
16	39010		Clock Face
17	39011		Hour Hand
18	39012		Minute Hand
19	39013		Second Hand
20	39014		Alarm Hand
21	38070		Clock Lens
--	40917		Envelope Assembly, Mounting Bracket & Screws
--	39223		Bulb

Order Parts From: PARTS DEPT. C/O

NuTone 

DIVISION

Madison and Red Bank Roads, Cincinnati, Ohio 45227

PRINTED IN U.S.A.