

# PARTS LIST

<b>MODEL</b>	MODEL 2515 ELECTRONICS
<b>EFFECTIVE DATE</b>	REVISED - SEPT. 1973

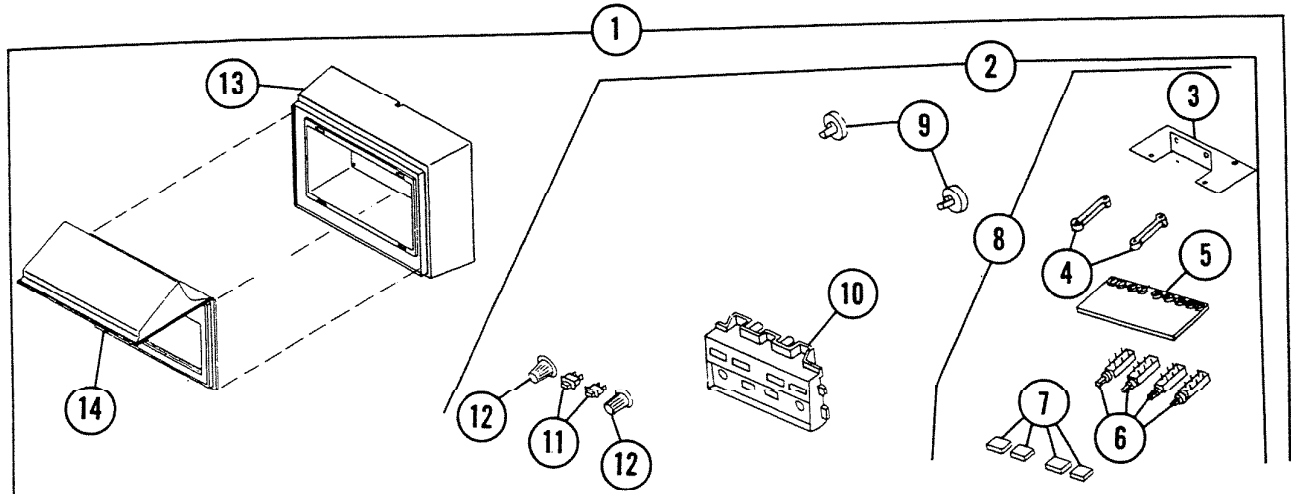

REF.	ORIGINAL PART NO.	* PART DESCRIPTION	MODEL USED ON	CURRENT REPLACEMENT PART NO.
1	41098-000	REMOTE CONTROL ASSY.	2515	15730-900
2	41094-000	CONTROL ASSY.	2515	41094-000
3	38225-000	BRACKET - PC BOARD	2515	38225-038
4	39088-000	SPACER	2515	39088-000
5	41096-000	PC BOARD ASSY.	2515	41096-000
6	34587-000	SWITCH	2515	34587-000
7	318/8-000	PUSHBUTTON	2515	31878-000
8	41095-000	PC BOARD & BRACKET ASSY.	2515	41095-000
9	34044-000	POTENTIOMETER (2 used - 1 for Channel "A" - 1 for Channel "B")	2515	34044-000
10	38223-000	PANEL-CONTROL INSERT	2515	38223-000
11	03721-000	PUSHBUTTON COMPLETE	2515	39280-000
12	39089-000	KNOB (2 REQUIRED)	2515	39089-000
13	32494-000	HOUSING SLEEVE	2515	38566-000
14	38374-000	COVER BEZEL	2515	38374-000
-	40046-000	ENVELOPE ASSY. MTG. HARDWARE (Not Shown)	2515	40046-000

**NuTone Division**  
**Scovill**

Order Parts From:  
Parts Department c/o NuTone  
P.O. Box 27 • Cincinnati, Ohio 45227

↑  
**NOTE:** Always order by  
current part number.

PL-2515