

EFFECTIVE DATE
June 1, 1968

NuTone

MODEL
2017
Horn Speaker

PARTS LIST

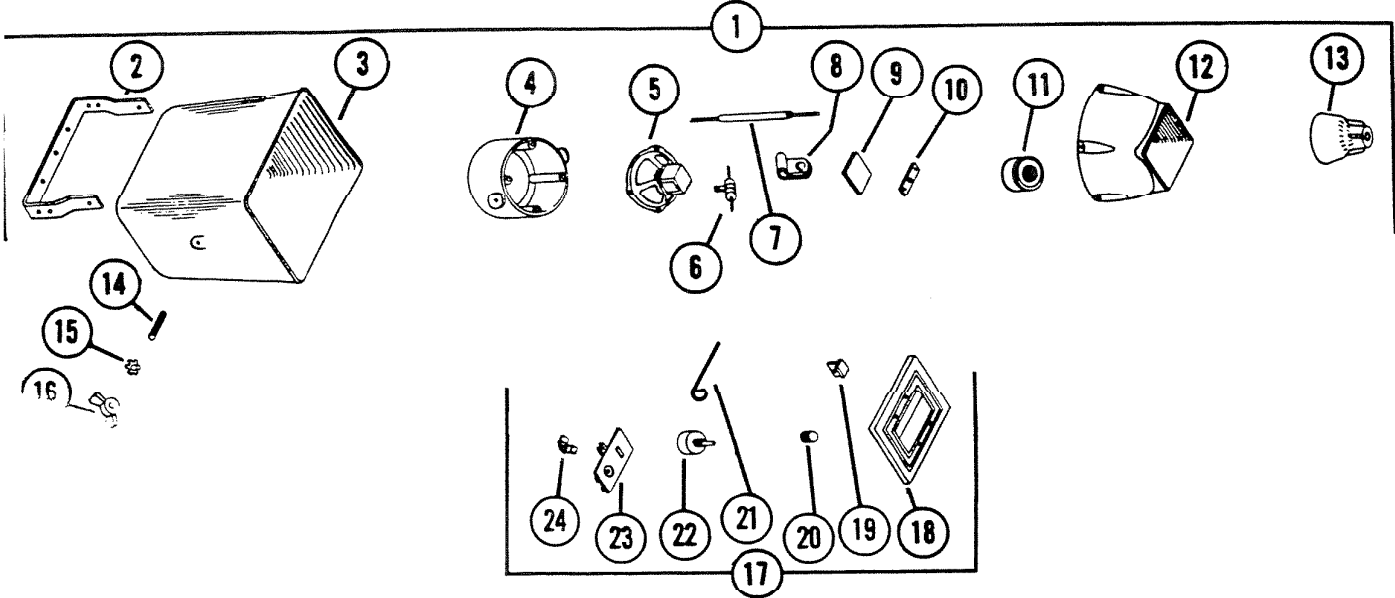

REF.	PART NO.		PART DESCRIPTION
1	40619		Horn Speaker Assembly, Ref. No.'s 2 thru 16
2	32148	*	"U" Bracket
3	32364	*	Horn
4	32365	*	Rear Housing
5	36023		Cone Speaker - 4 Ohm
6	35033	*	Condensor - 30 mfd
7	32570	*	Cable
8	31798	*	Cable Clamp
9	32360	*	Sound Absorber
10	32149	*	Unit Strap
11	36026		Unit Assembly (Speaker 4 Ohms)
12	32367	*	Front Housing
13	32368	*	Reflector

(PLEASE SEE OTHER SIDE)

PRICES SUBJECT TO CHANGE WITHOUT NOTICE

Order Parts From: PARTS DEPT. C/O

NuTone **SCOVILL**

DIVISION

Madison and Red Bank Rds., Cincinnati, O. 45227

*Part used on other model/s

Printed in the U.S.A.

REF.	PART NO.	PART DESCRIPTION
14	31795	* Stud (2 required)
15	31794	* Lock Washer
16	31796	* Wing Nut
17	40302	Bezel Assembly
18	32461	* Bezel
19	31453	* Pushbutton
20	31452	* Knob - Volume
21	32550	* Contact Wire
22	34020	* Potentiometer
23	32460	* Insert
24	31405	* Contact (2 required)
	40617	Envelope Assembly (NOT SHOWN)
	40618	Envelope Assembly (NOT SHOWN)

PRICES SUBJECT TO CHANGE WITHOUT NOTICE

Order Parts From: PARTS DEPT. C/O

NuTone 

DIVISION

Madison and Red Bank Rds., Cincinnati, O. 45227

*Part used on other model/s

Printed in the U.S.A.